igControl

Data Sheet Collection

Industry 4.0 Models



MW10Li03 V40



This multihead weigher is an Industry 4.0 product. Perform diagnosis or updates online from the technical service.

Ultimate electronics with 64bit CPU, allows ultrafast and accurate combination. High efficiency drivers for vibration and motion.

With 10 heads and ¼ litter volume it's optimal for dosing pharmaceutical products like pills or delicate and expensive like saffron or truffle, up to 60 d.p.m. and 0,1g of accuracy.

Functions for mixing, counting and calibrating are included in the firmware.

Firmware Features:

- Multi-Screen: Master / Slave support, secondary screen (tablet or mobile) can monitor the data from main control, via local network or via cloud worldwide.
- Multi-User: Remote users can login into the weigher, watch the camera in real time, get the production data not disturbing the operations in the main control.
- Windows API: Control and Monitoring of the machine can be shared to the customer ERP.
- Mobile App: Included Android app to login into the weigher via Bluetooth, local network or remote cloud and monitor the data in background or control the machine as main operator.
- Firmware Upgrade: The firmware of the CPU can be uploaded from the panel PC or cloud.

- 12" touch Panel PC, Windows 10 Pro
- Full integral control: weigher + packer, etc
- Microsoft Excel export for statistics
- Remote connection by cloud
- HD Webcam integrated
- Stainless Steel Full IP 65
- Mixing function using very few heads.
- Units-Counting (can weight at same time)
- Weight stability, detection and control
- Staggered dump, avoid product stuck
- Product alarm, pause when lack of product
- Motor sensor alarm, detects bucket failure
- Vibration alarm, detects feeder failure
- Auto-zero alarm, detects sticky product

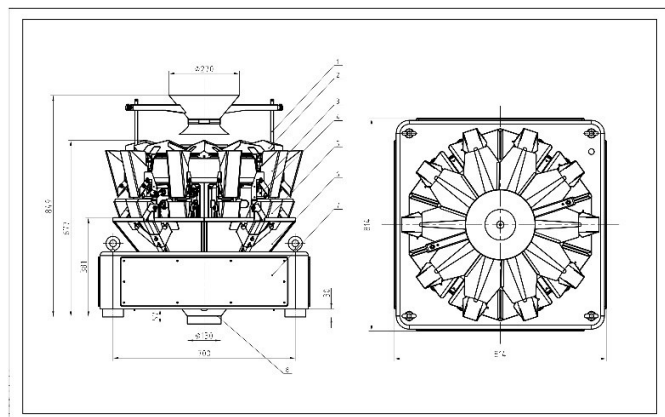

Data Sheet

MW14Li03 V40



This multihead weigher is an Industry 4.0 product. Perform diagnosis or updates online from the technical service.

Ultimate electronics with 64bit CPU, allows ultrafast and accurate combination. High efficiency drivers for vibration and motion.

With 14 heads and ¼ litter volume it's optimal for dosing pharmaceutical products like pills or delicate and expensive like saffron or truffle, up to 120 d.p.m. and 0,1g of accuracy.

Functions for mixing, counting and calibrating are included in the firmware.

Firmware Features:

- Multi-Screen: Master / Slave support, secondary screen (tablet or mobile) can monitor the data from main control, via local network or via cloud worldwide.
- Multi-User: Remote users can login into the weigher, watch the camera in real time, get the production data not disturbing the operations in the main control.
- Windows API: Control and Monitoring of the machine can be shared to the customer ERP.
- Mobile App: Included Android app to login into the weigher via Bluetooth, local network or remote cloud and monitor the data in background or control the machine as main operator.
- Firmware Upgrade: The firmware of the CPU can be uploaded from the panel PC or cloud.

- 12" touch Panel PC, Windows 10 Pro
- Full integral control: weigher + packer, etc
- Microsoft Excel export for statistics
- Remote connection by cloud
- HD Webcam integrated
- Stainless Steel Full IP 65
- Mixing function using very few heads.
- Units-Counting (can weight at same time)
- Weight stability, detection and control
- Staggered dump, avoid product stuck
- Product alarm, pause when lack of product
- Motor sensor alarm, detects bucket failure
- Vibration alarm, detects feeder failure
- Auto-zero alarm, detects sticky product

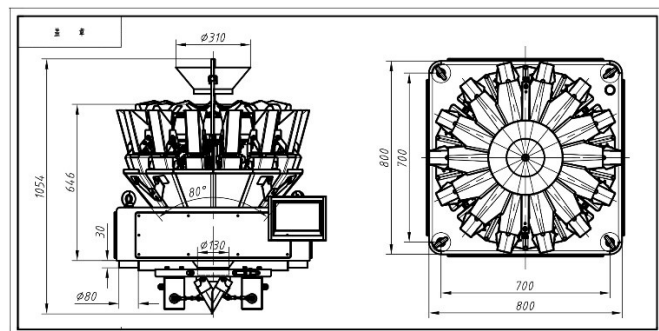

Data Sheet

MW14Li05 V40



This multihead weigher is an Industry 4.0 product. Perform diagnosis or updates online from the technical service.

Ultimate electronics with 64bit CPU, allows ultrafast and accurate combination. High efficiency drivers for vibration and motion.

With 14 heads and ½ litter volume it's optimal for dosing pharmaceutical products like pills or delicate and expensive like saffron or blueberry, up to 120 d.p.m. and 0,1g of accuracy.

Functions for mixing, counting and calibrating are included in the firmware.

Firmware Features:

- Multi-Screen: Master / Slave support, secondary screen (tablet or mobile) can monitor the data from main control, via local network or via cloud worldwide.
- Multi-User: Remote users can login into the weigher, watch the camera in real time, get the production data not disturbing the operations in the main control.
- Windows API: Control and Monitoring of the machine can be shared to the customer ERP.
- Mobile App: Included Android app to login into the weigher via Bluetooth, local network or remote cloud and monitor the data in background or control the machine as main operator.
- Firmware Upgrade: The firmware of the CPU can be uploaded from the panel PC or cloud.

- 12" touch Panel PC, Windows 10 Pro
- Full integral control: weigher + packer, etc
- Microsoft Excel export for statistics
- Remote connection by cloud
- HD Webcam integrated
- Stainless Steel Full IP 65
- Mixing function using very few heads.
- Units-Counting (can weight at same time)
- Weight stability, detection and control
- Staggered dump, avoid product stuck
- Product alarm, pause when lack of product
- Motor sensor alarm, detects bucket failure
- Vibration alarm, detects feeder failure
- Auto-zero alarm, detects sticky product

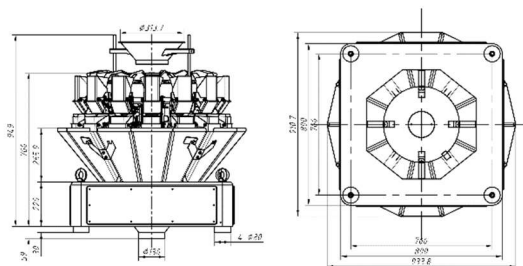

Data Sheet

MW16Li05 V40



This multihead weigher is an Industry 4.0 product. Perform diagnosis or updates online from the technical service.

Ultimate electronics with 64bit CPU, allows ultrafast and accurate combination. High efficiency drivers for vibration and motion.

With 16 heads and ½ litter volume it's optimal for mixing 2 products like muesli, or dump one product simultaneously over 2 baggers, up to 60 d.p.m. and 0,1g of accuracy.

Functions for mixing, counting and calibrating are included in the firmware.

Firmware Features:

- Multi-Screen: Master / Slave support, secondary screen (tablet or mobile) can monitor the data from main control, via local network or via cloud worldwide.
- Multi-User: Remote users can login into the weigher, watch the camera in real time, get the production data not disturbing the operations in the main control.
- Windows API: Control and Monitoring of the machine can be shared to the customer ERP.
- Mobile App: Included Android app to login into the weigher via Bluetooth, local network or remote cloud and monitor the data in background or control the machine as main operator.
- Firmware Upgrade: The firmware of the CPU can be uploaded from the panel PC or cloud.

- 12" touch Panel PC, Windows 10 Pro
- Full integral control: weigher + packer, etc
- Microsoft Excel export for statistics
- Remote connection by cloud
- HD Webcam integrated
- Stainless Steel Full IP 65
- Mixing function using very few heads.
- Units-Counting (can weight at same time)
- Weight stability, detection and control
- Staggered dump, avoid product stuck
- Product alarm, pause when lack of product
- Motor sensor alarm, detects bucket failure
- Vibration alarm, detects feeder failure
- Auto-zero alarm, detects sticky product

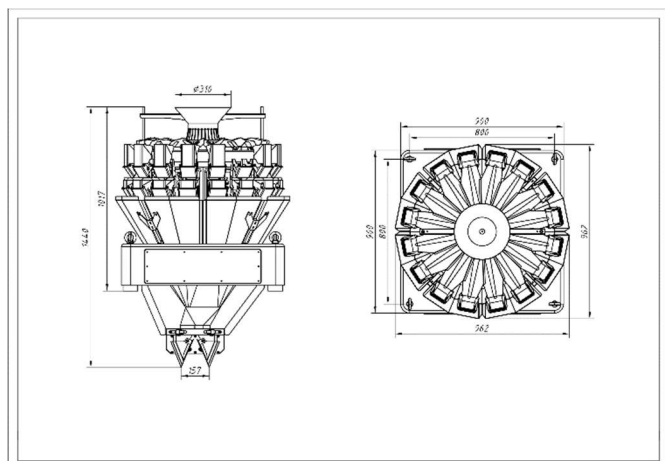

Data Sheet

MW24Li05 V40



This multihead weigher is an Industry 4.0 product. Perform diagnosis or updates online from the technical service.

Ultimate electronics with 64bit CPU, allows ultrafast and accurate combination. High efficiency drivers for vibration and motion.

With 24 heads and ½ litter volume it's optimal for mixing 4 products like muesli, or dump one product simultaneously over 4 baggers, up to 60 d.p.m. and 0,1g of accuracy.

Functions for mixing, counting and calibrating are included in the firmware.

Firmware Features:

- Multi-Screen: Master / Slave support, secondary screen (tablet or mobile) can monitor the data from main control, via local network or via cloud worldwide.
- Multi-User: Remote users can login into the weigher, watch the camera in real time, get the production data not disturbing the operations in the main control.
- Windows API: Control and Monitoring of the machine can be shared to the customer ERP.
- Mobile App: Included Android app to login into the weigher via Bluetooth, local network or remote cloud and monitor the data in background or control the machine as main operator.
- Firmware Upgrade: The firmware of the CPU can be uploaded from the panel PC or cloud.

- 12" touch Panel PC, Windows 10 Pro
- Full integral control: weigher+packer, etc.
- Microsoft Excel export for statistics
- Remote connection by cloud
- HD Webcam integrated
- Stainless Steel Full IP 65
- Mixing function using very few heads.
- Units-Counting (can weight at same time)
- Weight stability, detection and control
- Staggered dump, avoid product stuck
- Product alarm, pause when lack of product
- Motor sensor alarm, detects bucket failure
- Vibration alarm, detects feeder failure
- Auto-zero alarm, detects sticky product

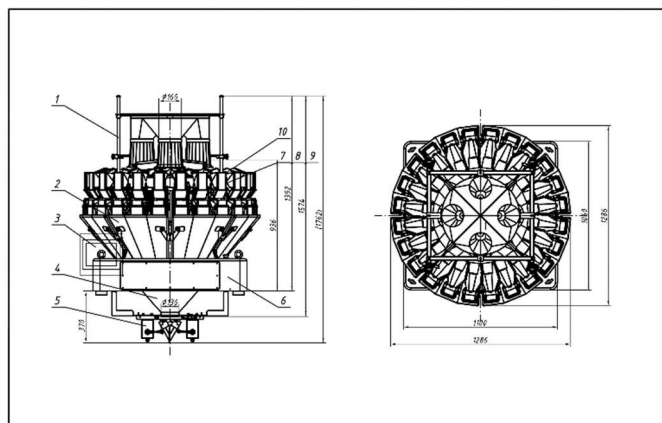

Data Sheet

MW32Li05 V40



This multihead weigher is an Industry 4.0 product. Perform diagnosis or updates online from the technical service.

Ultimate electronics with 64bit CPU, allows ultrafast and accurate combination. High efficiency drivers for vibration and motion.

With 32 heads and ½ litter volume it's optimal for mixing 4 products like muesli, or dump one product simultaneously over 4 baggers, up to 60 d.p.m. and 0,1g of accuracy.

Functions for mixing, counting and calibrating are included in the firmware.

Firmware Features:

- Multi-Screen: Master / Slave support, secondary screen (tablet or mobile) can monitor the data from main control, via local network or via cloud worldwide.
- Multi-User: Remote users can login into the weigher, watch the camera in real time, get the production data not disturbing the operations in the main control.
- Windows API: Control and Monitoring of the machine can be shared to the customer ERP.
- Mobile App: Included Android app to login into the weigher via Bluetooth, local network or remote cloud and monitor the data in background or control the machine as main operator.
- Firmware Upgrade: The firmware of the CPU can be uploaded from the panel PC or cloud.

- 12" touch Panel PC, Windows 10 Pro
- Full integral control: weigher+packer, etc.
- Microsoft Excel export for statistics
- Remote connection by cloud
- HD Webcam integrated
- Stainless Steel Full IP 65
- Mixing function using very few heads.
- Units-Counting (can weight at same time)
- Weight stability, detection and control
- Staggered dump, avoid product stuck
- Product alarm, pause when lack of product
- Motor sensor alarm, detects bucket failure
- Vibration alarm, detects feeder failure
- Auto-zero alarm, detects sticky product

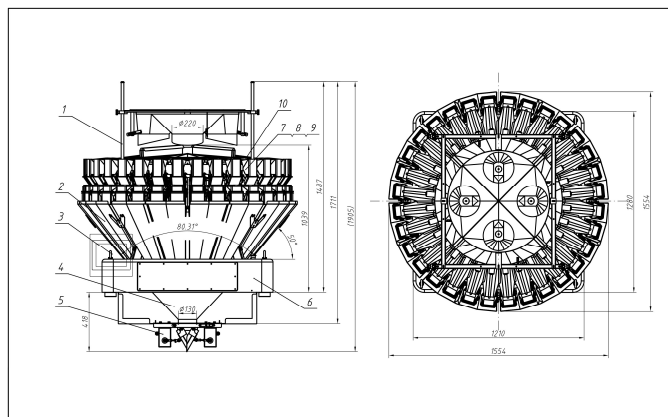

Data Sheet

MW10Li15 V40



This multihead weigher is an Industry 4.0 product. Perform diagnosis or updates online from the technical service.

Ultimate electronics with 64bit CPU, allows ultrafast and accurate combination. High efficiency drivers for vibration and motion.

With 10 heads and smooth surface it's optimal for dosing dry products like nuts, beans or sweets, up to 60 d.p.m. and 1g of accuracy.

Functions for mixing, counting and calibrating are included in the firmware.

Firmware Features:

- Multi-Screen: Master / Slave support, secondary screen (tablet or mobile) can monitor the data from main control, via local network or via cloud worldwide.
- Multi-User: Remote users can login into the weigher, watch the camera in real time, get the production data not disturbing the operations in the main control.
- Windows API: Control and Monitoring of the machine can be shared to the customer ERP.
- Mobile App: Included Android app to login into the weigher via Bluetooth, local network or remote cloud and monitor the data in background or control the machine as main operator.
- Firmware Upgrade: The firmware of the CPU can be uploaded from the panel PC or cloud.

- 12" touch Panel PC with Windows 10 Pro
- Full integral control: weigher + packer, etc...
- Microsoft Excel export for statistics
- Remote connection by cloud
- HD Webcam integrated
- Stainless Steel Full IP 65
- Mixing function using very few heads.
- Units-Counting (can weight at same time)
- Weight stability, detection and control
- Staggered dump, avoid product stuck
- Product alarm, pause when lack of product
- Motor sensor alarm, detects bucket failure
- Vibration alarm, detects feeder failure
- Auto-zero alarm, detects sticky product

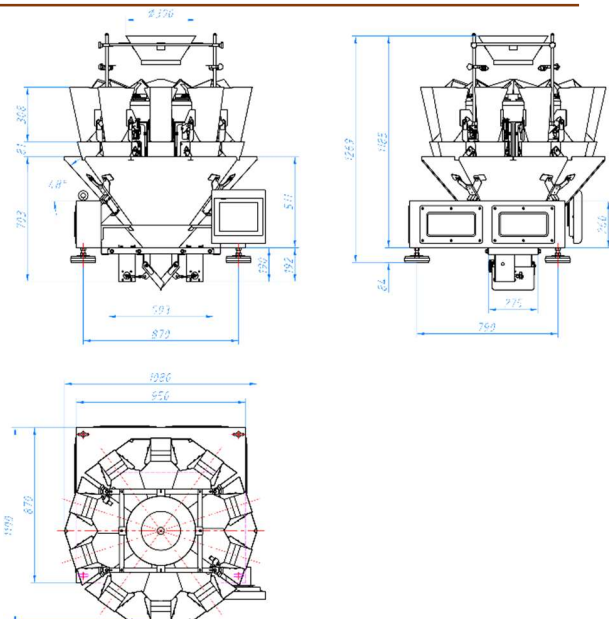

MW10La15 V40



This multihead weigher is an Industry 4.0 product. Perform diagnosis or updates online from the technical service.

Ultimate electronics with 64bit CPU, allows ultrafast and accurate combination. High efficiency drivers for vibration and motion.

With 10 heads and dimple surface it's optimal for dosing sticky and frozen products like meat or plums, up to 50 d.p.m. and 1g of accuracy.

Functions for mixing, counting and calibrating are included in the firmware.

Firmware Features:

- Multi-Screen: Master / Slave support, secondary screen (tablet or mobile) can monitor the data from main control, via local network or via cloud worldwide.
- Multi-User: Remote users can login into the weigher, watch the camera in real time, get the production data not disturbing the operations in the main control.
- Windows API: Control and Monitoring of the machine can be shared to the customer ERP.
- Mobile App: Included Android app to login into the weigher via Bluetooth, local network or remote cloud and monitor the data in background or control the machine as main operator.
- Firmware Upgrade: The firmware of the CPU can be uploaded from the panel PC or cloud.

- 12" touch Panel PC with Windows 10
- Full integral control: weigher + packer
- Microsoft Excel export for statistics
- Remote connection by cloud
- HD Webcam integrated
- Stainless Steel Full IP 65
- Mixing function using very few heads.
- Units-Counting, can weight at same time
- Weight stability, detection and control
- Staggered dump, avoid product stuck
- Product alarm, pause when lack of product
- Motor sensor alarm, detects bucket failure
- Vibration alarm, detects feeder failure
- Auto-zero alarm, detects sticky product

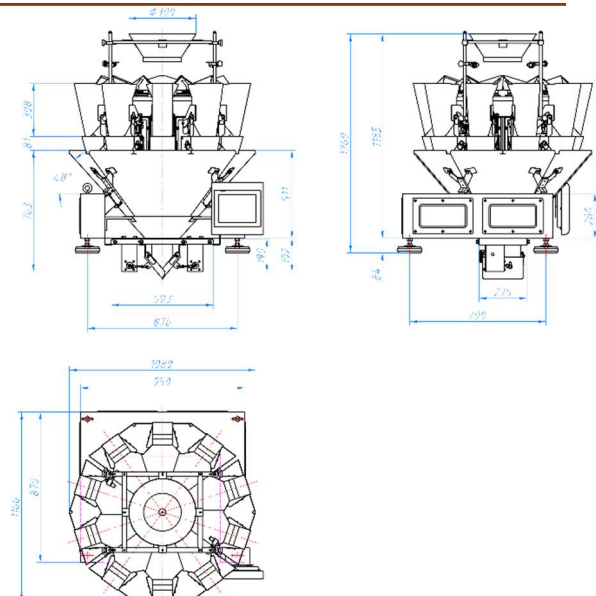

Data Sheet

MW14Li15 V40



This multihead weigher is an Industry 4.0 product. Perform diagnosis or updates online from the technical service.

Ultimate electronics with 64bit CPU, allows ultrafast and accurate combination. High efficiency drivers for vibration and motion.

With 14 heads and smooth surface it's optimal for dosing dry products like nuts, beans or sweets, up to 120 d.p.m. and 1g of accuracy.

Functions for mixing, counting and calibrating are included in the firmware.

Firmware Features:

- Multi-Screen: Master / Slave support, secondary screen (tablet or mobile) can monitor the data from main control, via local network or via cloud worldwide.
- Multi-User: Remote users can login into the weigher, watch the camera in real time, get the production data not disturbing the operations in the main control.
- Windows API: Control and Monitoring of the machine can be shared to the customer ERP.
- Mobile App: Included Android app to login into the weigher via Bluetooth, local network or remote cloud and monitor the data in background or control the machine as main operator.
- Firmware Upgrade: The firmware of the CPU can be uploaded from the panel PC or cloud.

- 12" touch Panel PC Windows 10 Pro
- Full integral control: weigher + packer
- Microsoft Excel export for statistics
- Remote connection by cloud
- HD Webcam integrated
- Stainless Steel Full IP 65
- Mixing function using very few heads.
- Units-Counting (can weight at same time)
- Weight stability, detection and control
- Staggered dump, avoid product stuck
- Product alarm, pause when lack of product
- Motor sensor alarm, detects bucket failure
- Vibration alarm, detects feeder failure
- Auto-zero alarm, detects sticky product

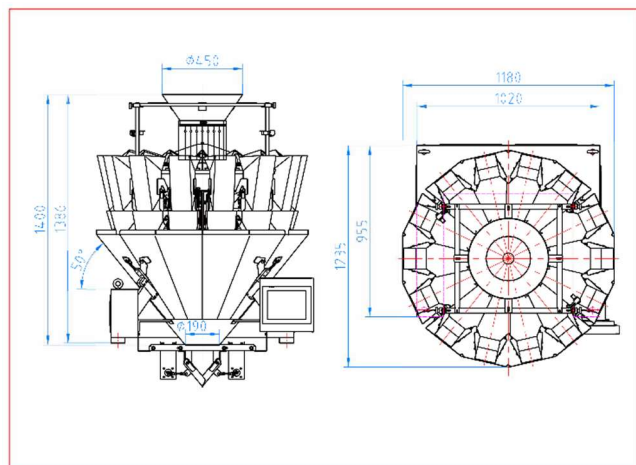

Data Sheet

MW14La15 V40



This multihead weigher is an Industry 4.0 product. Perform diagnosis or updates online from the technical service.

Ultimate electronics with 64bit CPU, allows ultrafast and accurate combination. High efficiency drivers for vibration and motion.

With 14 heads and dimple surface it's optimal for dosing sticky and frozen products like meat or plums up to 100 d.p.m. and 1g of accuracy.

Functions for mixing, counting and calibrating are included in the firmware.

Firmware Features:

- Multi-Screen: Master / Slave support, secondary screen (tablet or mobile) can monitor the data from main control, via local network or via cloud worldwide.
- Multi-User: Remote users can login into the weigher, watch the camera in real time, get the production data not disturbing the operations in the main control.
- Windows API: Control and Monitoring of the machine can be shared to the customer ERP.
- Mobile App: Included Android app to login into the weigher via Bluetooth, local network or remote cloud and monitor the data in background or control the machine as main operator.
- Firmware Upgrade: The firmware of the CPU can be uploaded from the panel PC or cloud.

- 12" touch Panel PC Windows 10 Pro
- Full integral control: weigher + packer
- Microsoft Excel export for statistics
- Remote connection by cloud
- HD Webcam integrated
- Stainless Steel Full IP 65
- Mixing function using very few heads.
- Units-Counting (can weight at same time)
- Weight stability, detection and control
- Staggered dump, avoid product stuck
- Product alarm, pause when lack of product
- Motor sensor alarm, detects bucket failure
- Vibration alarm, detects feeder failure
- Auto-zero alarm, detects sticky product

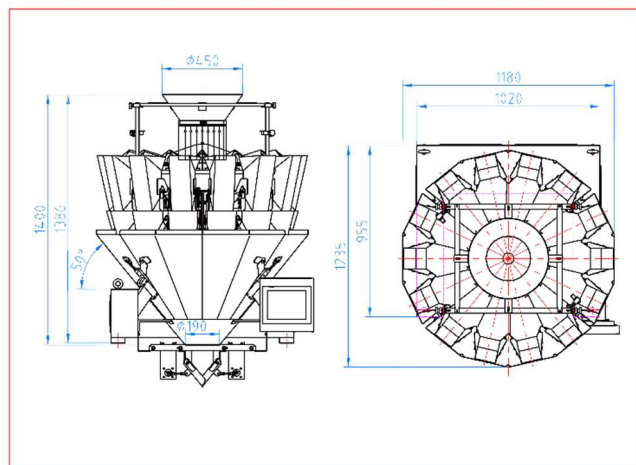

Data Sheet

MW14La15 S60



This multihead weigher is an Industry 4.0 product. Perform diagnosis or updates online from the technical service.

Ultimate electronics with 64bit CPU, allows ultrafast and accurate combination. High efficiency drivers for vibration and motion.

With 14 heads, dimple surface, inclined pans and 60° chutes it's optimal for dosing very sticky products like grated cheese or cocked food up to 80 d.p.m. and 1g of accuracy..

Functions for mixing, counting and calibrating are included in the firmware.

Firmware Features:

- Multi-Screen: Master / Slave support, secondary screen (tablet or mobile) can monitor the data from main control, via local network or via cloud worldwide.
- Multi-User: Remote users can login into the weigher, watch the camera in real time, get the production data not disturbing the operations in the main control.
- Windows API: Control and Monitoring of the machine can be shared to the customer ERP.
- Mobile App: Included Android app to login into the weigher via Bluetooth, local network or remote cloud and monitor the data in background or control the machine as main operator.
- Firmware Upgrade: The firmware of the CPU can be uploaded from the panel PC or cloud.

- 12" touch Panel PC Windows 10 Pro
- Full integral control: weigher + packer
- Microsoft Excel export for statistics
- Remote connection by cloud
- HD Webcam integrated
- Stainless Steel Full IP 65
- Mixing function using very few heads.
- Units-Counting (can weight at same time)
- Weight stability, detection and control
- Staggered dump, avoid product stuck
- Product alarm, pause when lack of product
- Motor sensor alarm, detects bucket failure
- Vibration alarm, detects feeder failure
- Auto-zero alarm, detects sticky product

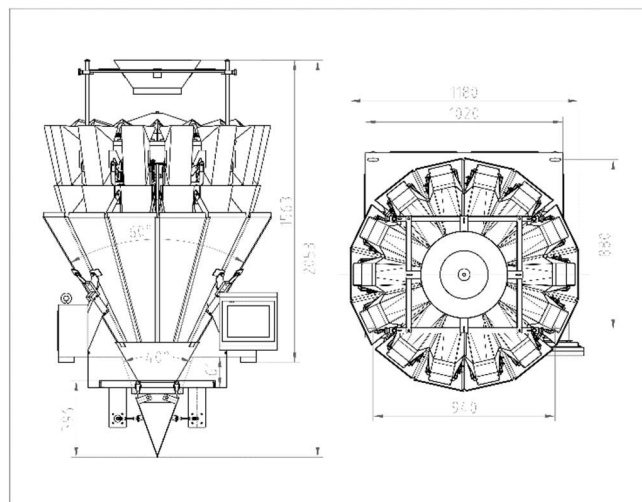

Data Sheet

MW16Li15 V40



This multihead weigher is an Industry 4.0 product. Perform diagnosis or updates online from the technical service.

Ultimate electronics with 64bit CPU, allows ultrafast and accurate combination. High efficiency drivers for vibration and motion.

With 16 heads and 1.5 litter volume, it's optimal for mixing 2 products like dry fruits, or dump one product simultaneously over 2 baggers, up to 60 d.p.m. each, and 1g of accuracy.

Functions for mixing, counting and calibrating are included in the firmware.

Firmware Features:

- Multi-Screen: Master / Slave support, secondary screen (tablet or mobile) can monitor the data from main control, via local network or via cloud worldwide.
- Multi-User: Remote users can login into the weigher, watch the camera in real time, get the production data not disturbing the operations in the main control.
- Windows API: Control and Monitoring of the machine can be shared to the customer ERP.
- Mobile App: Included Android app to login into the weigher via Bluetooth, local network or remote cloud and monitor the data in background or control the machine as main operator.
- Firmware Upgrade: The firmware of the CPU can be uploaded from the panel PC or cloud.

- 12" touch Panel PC, Windows 10 Pro
- Full integral control: weigher + packer, etc
- Microsoft Excel export for statistics
- Remote connection by cloud
- HD Webcam integrated
- Stainless Steel Full IP 65
- Mixing function using very few heads.
- Units-Counting (can weight at same time)
- Weight stability, detection and control
- Staggered dump, avoid product stuck
- Product alarm, pause when lack of product
- Motor sensor alarm, detects bucket failure
- Vibration alarm, detects feeder failure
- Auto-zero alarm, detects sticky product

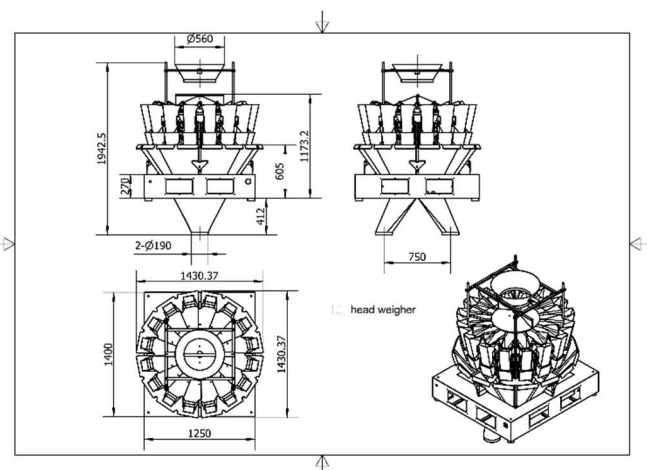

Data Sheet

MW24Li15 V40



This multihead weigher is an Industry 4.0 product. Perform diagnosis or updates online from the technical service.

Ultimate electronics with 64bit CPU, allows ultrafast and accurate combination. High efficiency drivers for vibration and motion.

With 24 heads and 1,5 litter volume it's optimal for mixing 2 or 4 products like dry fruits, or dump one product simultaneously over 2 or 4 baggers, up to 60 d.p.m. and 0,1g of accuracy.

Functions for mixing, counting and calibrating are included in the firmware.

Firmware Features:

- Multi-Screen: Master / Slave support, secondary screen (tablet or mobile) can monitor the data from main control, via local network or via cloud worldwide.
- Multi-User: Remote users can login into the weigher, watch the camera in real time, get the production data not disturbing the operations in the main control.
- Windows API: Control and Monitoring of the machine can be shared to the customer ERP.
- Mobile App: Included Android app to login into the weigher via Bluetooth, local network or remote cloud and monitor the data in background or control the machine as main operator.
- Firmware Upgrade: The firmware of the CPU can be uploaded from the panel PC or cloud.

- 12" touch Panel PC, Windows 10 Pro
- Full integral control: weigher+packer, etc.
- Microsoft Excel export for statistics
- Remote connection by cloud
- HD Webcam integrated
- Stainless Steel Full IP 65
- Mixing function using very few heads.
- Units-Counting (can weight at same time)
- Weight stability, detection and control
- Staggered dump, avoid product stuck
- Product alarm, pause when lack of product
- Motor sensor alarm, detects bucket failure
- Vibration alarm, detects feeder failure
- Auto-zero alarm, detects sticky product

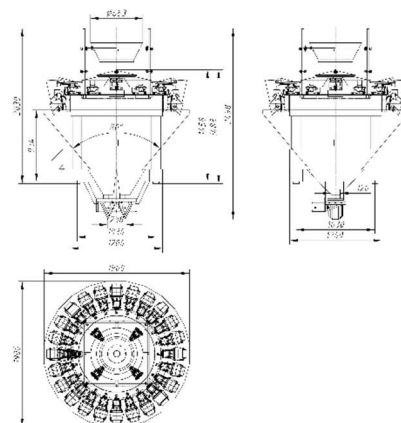

Data Sheet

MW32Li15 V40



This multihead weigher is an Industry 4.0 product. Perform diagnosis or updates online from the technical service.

Ultimate electronics with 64bit CPU, allows ultrafast and accurate combination. High efficiency drivers for vibration and motion.

With 32 heads and 1.5 litter volume it's optimal for mixing 2 or 4 products like dry fruits, or dump one product simultaneously over 2 or 4 baggers, up to 60 d.p.m. each, and 1g of accuracy.

Functions for mixing, counting and calibrating are included in the firmware.

Firmware Features:

- Multi-Screen: Master / Slave support, secondary screen (tablet or mobile) can monitor the data from main control, via local network or via cloud worldwide.
- Multi-User: Remote users can login into the weigher, watch the camera in real time, get the production data not disturbing the operations in the main control.
- Windows API: Control and Monitoring of the machine can be shared to the customer ERP.
- Mobile App: Included Android app to login into the weigher via Bluetooth, local network or remote cloud and monitor the data in background or control the machine as main operator.
- Firmware Upgrade: The firmware of the CPU can be uploaded from the panel PC or cloud.

- 12" touch Panel PC, Windows 10 Pro
- Full integral control: weigher+packer, etc.
- Microsoft Excel export for statistics
- Remote connection by cloud
- HD Webcam integrated
- Stainless Steel Full IP 65
- Mixing function using very few heads.
- Units-Counting (can weight at same time)
- Weight stability, detection and control
- Staggered dump, avoid product stuck
- Product alarm, pause when lack of product
- Motor sensor alarm, detects bucket failure
- Vibration alarm, detects feeder failure
- Auto-zero alarm, detects sticky product

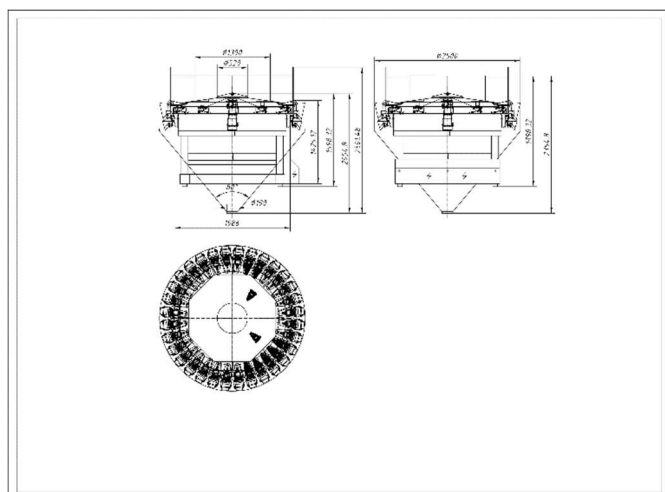

Data Sheet

MW10Li25 V40



This multihead weigher is an Industry 4.0 product. Perform diagnosis or updates online from the technical service.

Ultimate electronics with 64bit CPU, allows ultrafast and accurate combination. High efficiency drivers for vibration and motion.

With 10 heads and smooth surface it's optimal for dosing dry products like nuts, beans or sweets, up to 60 d.p.m. and 1g of accuracy.

Functions for mixing, counting and calibrating are included in the firmware.

Firmware Features:

- Multi-Screen: Master / Slave support, secondary screen (tablet or mobile) can monitor the data from main control, via local network or via cloud worldwide.
- Multi-User: Remote users can login into the weigher, watch the camera in real time, get the production data not disturbing the operations in the main control.
- Windows API: Control and Monitoring of the machine can be shared to the customer ERP.
- Mobile App: Included Android app to login into the weigher via Bluetooth, local network or remote cloud and monitor the data in background or control the machine as main operator.
- Firmware Upgrade: The firmware of the CPU can be uploaded from the panel PC or cloud.

- 12" touch Panel PC with Windows 10
- Full integral control: weigher + packer
- Microsoft Excel export for statistics
- Remote connection by cloud
- HD Webcam integrated
- Stainless Steel Full IP 65
- Mixing function using very few heads.
- Units-Counting, can weight at same time
- Weight stability, detection and control
- Staggered dump, avoid product stuck
- Product alarm, pause when lack of product
- Motor sensor alarm, detects bucket failure
- Vibration alarm, detects feeder failure
- Auto-zero alarm, detects sticky product

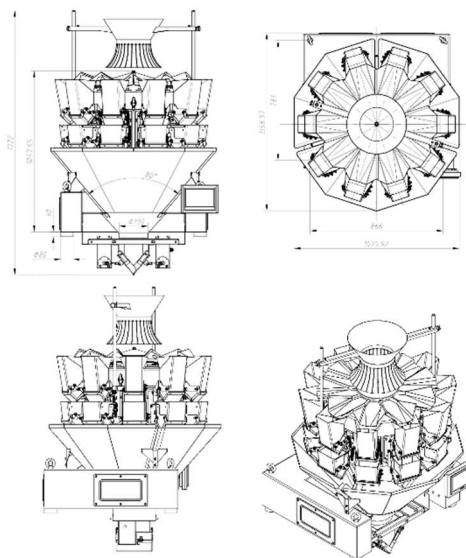

Data Sheet

MW10La25 V40



This multihead weigher is an Industry 4.0 product. Perform diagnosis or updates online from the technical service.

Ultimate electronics with 64bit CPU, allows ultrafast and accurate combination. High efficiency drivers for vibration and motion.

With 10 heads and dimple surface it's optimal for dosing sticky and frozen products like meat or plums, up to 50 d.p.m. and 1g of accuracy.

Functions for mixing, counting and calibrating are included in the firmware.

Firmware Features:

- Multi-Screen: Master / Slave support, secondary screen (tablet or mobile) can monitor the data from main control, via local network or via cloud worldwide.
- Multi-User: Remote users can login into the weigher, watch the camera in real time, get the production data not disturbing the operations in the main control.
- Windows API: Control and Monitoring of the machine can be shared to the customer ERP.
- Mobile App: Included Android app to login into the weigher via Bluetooth, local network or remote cloud and monitor the data in background or control the machine as main operator.
- Firmware Upgrade: The firmware of the CPU can be uploaded from the panel PC or cloud.

- 12" touch Panel PC with Windows 10
- Full integral control: weigher + packer
- Microsoft Excel export for statistics
- Remote connection by cloud
- HD Webcam integrated
- Stainless Steel Full IP 65
- Mixing function using very few heads.
- Units-Counting, can weight at same time
- Weight stability, detection and control
- Staggered dump, avoid product stuck
- Product alarm, pause when lack of product
- Motor sensor alarm, detects bucket failure
- Vibration alarm, detects feeder failure
- Auto-zero alarm, detects sticky product

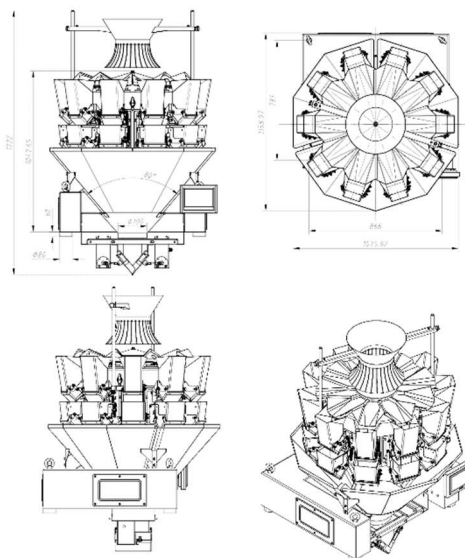

Data Sheet

MW14Li25 V40

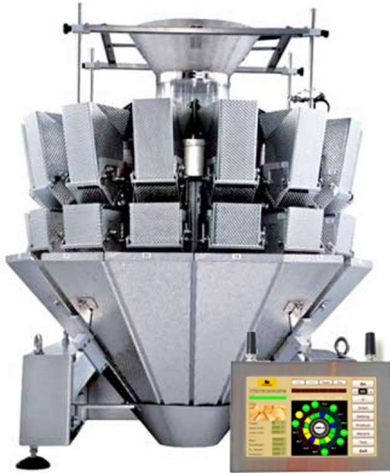

This multihead weigher is an Industry 4.0 product. Perform diagnosis or updates online from the technical service.

Ultimate electronics with 64bit CPU, allows ultrafast and accurate combination. High efficiency drivers for vibration and motion.

With 14 heads and smooth surface it's optimal for dosing dry products like nuts, beans or sweets, up to 120 d.p.m. and 1g of accuracy.

Functions for mixing, counting and calibrating are included in the firmware.

Firmware Features:

- Multi-Screen: Master / Slave support, secondary screen (tablet or mobile) can monitor the data from main control, via local network or via cloud worldwide.
- Multi-User: Remote users can login into the weigher, watch the camera in real time, get the production data not disturbing the operations in the main control.
- Windows API: Control and Monitoring of the machine can be shared to the customer ERP.
- Mobile App: Included Android app to login into the weigher via Bluetooth, local network or remote cloud and monitor the data in background or control the machine as main operator.
- Firmware Upgrade: The firmware of the CPU can be uploaded from the panel PC or cloud.

- 12" touch Panel PC Windows 10
- Full integral control: weigher + packer
- Microsoft Excel export for statistics
- Remote connection by cloud
- HD Webcam integrated
- Stainless Steel Full IP 65
- Mixing function using very few heads.
- Units-Counting, can weight at same time
- Weight stability, detection and control
- Staggered dump, avoid product stuck
- Product alarm, pause when lack of product
- Motor sensor alarm, detects bucket failure
- Vibration alarm, detects feeder failure
- Auto-zero alarm, detects sticky product

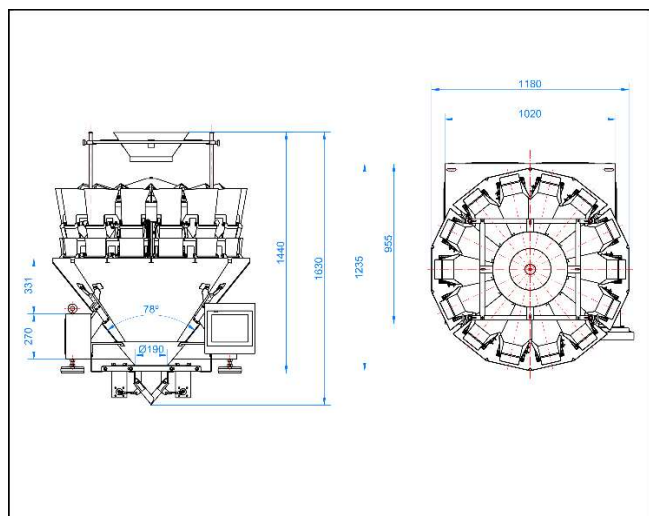

MW14Li25 S30



This multihead weigher is an Industry 4.0 product. Perform diagnosis or updates online from the technical service.

Ultimate electronics with 64bit CPU, allows ultrafast and accurate combination. High efficiency drivers for vibration and motion.

With 14 heads, plain surface, and 30° chutes it's optimal for dosing fragile products like ice, blueberry or cherry tomato, up to 100 d.p.m. and 1g of accuracy.

Functions for mixing, counting and calibrating are included in the firmware.

Firmware Features:

- **Multi-Screen:** Master / Slave support, secondary screen (tablet or mobile) can monitor the data from main control, via local network or via cloud worldwide.
- **Multi-User:** Remote users can login into the weigher, watch the camera in real time, get the production data not disturbing the operations in the main control.
- **Windows API:** Control and Monitoring of the machine can be shared to the customer ERP.
- **Mobile App:** Included Android app to login into the weigher via Bluetooth, local network or remote cloud and monitor the data in background or control the machine as main operator.
- **Firmware Upgrade:** The firmware of the CPU can be uploaded from the panel PC or cloud.

- 12" touch Panel PC Windows 10 Pro
- Full integral control: weigher + packer
- Microsoft Excel export for statistics
- Remote connection by cloud
- HD Webcam integrated
- Stainless Steel Full IP 65
- Mixing function using very few heads.
- Units-Counting (can weight at same time)
- Weight stability, detection and control
- Staggered dump, avoid product stuck
- Product alarm, pause when lack of product
- Motor sensor alarm, detects bucket failure
- Vibration alarm, detects feeder failure
- Auto-zero alarm, detects sticky product

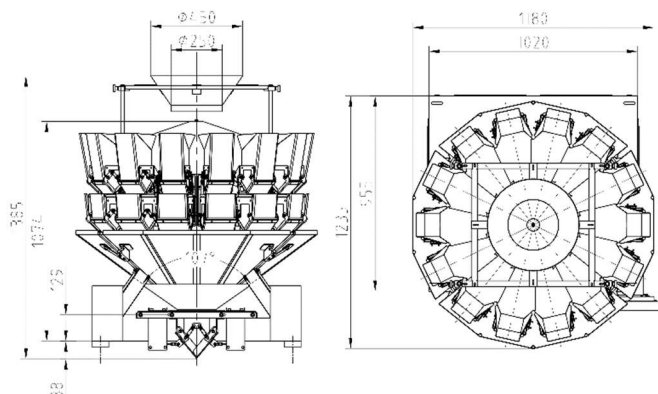

Data Sheet

MW14La25 V40

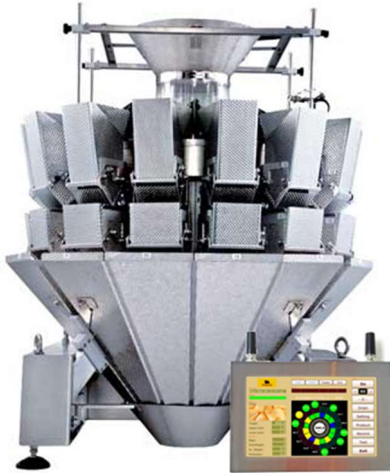

This multihead weigher is an Industry 4.0 product. Perform diagnosis or updates online from the technical service.

Ultimate electronics with 64bit CPU, allows ultrafast and accurate combination. High efficiency drivers for vibration and motion.

With 14 heads and dimple surface it's optimal for dosing sticky and frozen products like meat or plums up to 100 d.p.m. and 1g of accuracy.

Functions for mixing, counting and calibrating are included in the firmware.

Firmware Features:

- Multi-Screen: Master / Slave support, secondary screen (tablet or mobile) can monitor the data from main control, via local network or via cloud worldwide.
- Multi-User: Remote users can login into the weigher, watch the camera in real time, get the production data not disturbing the operations in the main control.
- Windows API: Control and Monitoring of the machine can be shared to the customer ERP.
- Mobile App: Included Android app to login into the weigher via Bluetooth, local network or remote cloud and monitor the data in background or control the machine as main operator.
- Firmware Upgrade: The firmware of the CPU can be uploaded from the panel PC or cloud.

- 12" touch Panel PC Windows 10
- Full integral control: weigher + packer
- Microsoft Excel export for statistics
- Remote connection by cloud
- HD Webcam integrated
- Stainless Steel Full IP 65
- Mixing function using very few heads.
- Units-Counting, can weight at same time
- Weight stability, detection and control
- Staggered dump, avoid product stuck
- Product alarm, pause when lack of product
- Motor sensor alarm, detects bucket failure
- Vibration alarm, detects feeder failure
- Auto-zero alarm, detects sticky product

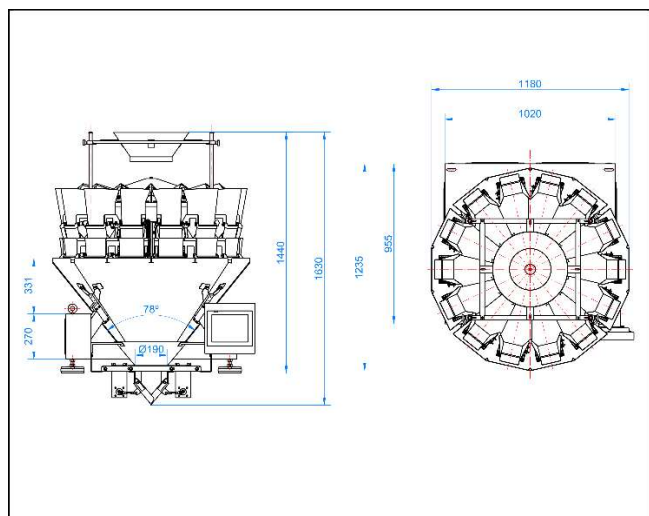

Data Sheet

MW10Li50 V40



This multihead weigher is an Industry 4.0 product. Perform diagnosis or updates online from the technical service.

Ultimate electronics with 64bit CPU, allows ultrafast and accurate combination. High efficiency drivers for vibration and motion.

With 10 heads, smooth surface and 5L volume, it's optimal for dosing big dry products garlic, onion or potatoes, up to 50 d.p.m. and 1g of accuracy.

Functions for mixing, counting and calibrating are included in the firmware.

Firmware Features:

- Multi-Screen: Master / Slave support, secondary screen (tablet or mobile) can monitor the data from main control, via local network or via cloud worldwide.
- Multi-User: Remote users can login into the weigher, watch the camera in real time, get the production data not disturbing the operations in the main control.
- Windows API: Control and Monitoring of the machine can be shared to the customer ERP.
- Mobile App: Included Android app to login into the weigher via Bluetooth, local network or remote cloud and monitor the data in background or control the machine as main operator.
- Firmware Upgrade: The firmware of the CPU can be uploaded from the panel PC or cloud.

- 12" touch Panel PC with Windows 10
- Full integral control: weigher + packer
- Microsoft Excel export for statistics
- Remote connection by cloud
- HD Webcam integrated
- Stainless Steel Full IP 65
- Mixing function using very few heads.
- Units-Counting, can weight at same time
- Weight stability, detection and control
- Staggered dump, avoid product stuck
- Product alarm, pause when lack of product
- Motor sensor alarm, detects bucket failure
- Vibration alarm, detects feeder failure
- Auto-zero alarm, detects sticky product

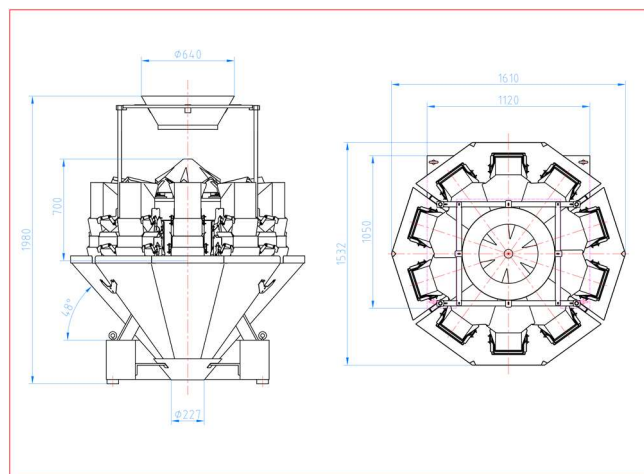

Data Sheet

MW10La50 V40



This multihead weigher is an Industry 4.0 product. Perform diagnosis or updates online from the technical service.

Ultimate electronics with 64bit CPU, allows ultrafast and accurate combination. High efficiency drivers for vibration and motion.

With 10 heads, dimple surface and 5L volume it's optimal for dosing big sticky or frozen products like meat balls, bakery or fish, up to 40 d.p.m. and 1g of accuracy.

Functions for mixing, counting and calibrating are included in the firmware.

Firmware Features:

- Multi-Screen: Master / Slave support, secondary screen (tablet or mobile) can monitor the data from main control, via local network or via cloud worldwide.
- Multi-User: Remote users can login into the weigher, watch the camera in real time, get the production data not disturbing the operations in the main control.
- Windows API: Control and Monitoring of the machine can be shared to the customer ERP.
- Mobile App: Included Android app to login into the weigher via Bluetooth, local network or remote cloud and monitor the data in background or control the machine as main operator.
- Firmware Upgrade: The firmware of the CPU can be uploaded from the panel PC or cloud.

- 12" touch Panel PC with Windows 10
- Full integral control: weigher + packer
- Microsoft Excel export for statistics
- Remote connection by cloud
- HD Webcam integrated
- Stainless Steel Full IP 65
- Mixing function using very few heads.
- Units-Counting, can weight at same time
- Weight stability, detection and control
- Staggered dump, avoid product stuck
- Product alarm, pause when lack of product
- Motor sensor alarm, detects bucket failure
- Vibration alarm, detects feeder failure
- Auto-zero alarm, detects sticky product

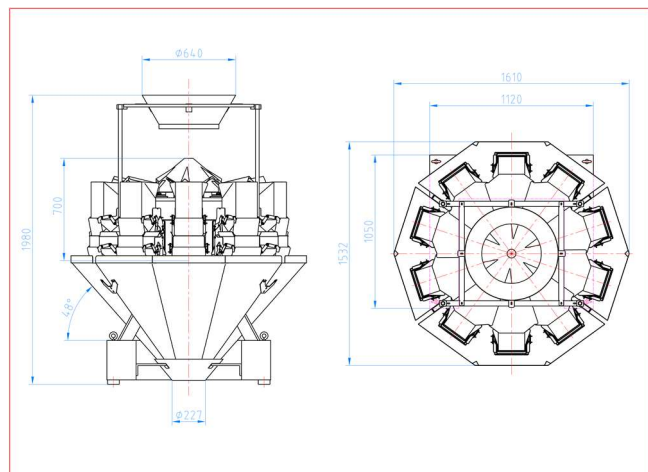

Data Sheet

MW14Li50 V40



This multihead weigher is an Industry 4.0 product. Perform diagnosis or updates online from the technical service.

Ultimate electronics with 64bit CPU, allows ultrafast and accurate combination. High efficiency drivers for vibration and motion.

With 10 heads, smooth surface and 5L volume, it's optimal for dosing big dry products garlic, onion or potatoes, up to 100 d.p.m. and 1g of accuracy.

Functions for mixing, counting and calibrating are included in the firmware.

Firmware Features:

- Multi-Screen: Master / Slave support, secondary screen (tablet or mobile) can monitor the data from main control, via local network or via cloud worldwide.
- Multi-User: Remote users can login into the weigher, watch the camera in real time, get the production data not disturbing the operations in the main control.
- Windows API: Control and Monitoring of the machine can be shared to the customer ERP.
- Mobile App: Included Android app to login into the weigher via Bluetooth, local network or remote cloud and monitor the data in background or control the machine as main operator.
- Firmware Upgrade: The firmware of the CPU can be uploaded from the panel PC or cloud.

- 12" touch Panel PC with Windows 10
- Full integral control: weigher + packer
- Microsoft Excel export for statistics
- Remote connection by cloud
- HD Webcam integrated
- Stainless Steel Full IP 65
- Mixing function using very few heads.
- Units-Counting, can weight at same time
- Weight stability, detection and control
- Staggered dump, avoid product stuck
- Product alarm, pause when lack of product
- Motor sensor alarm, detects bucket failure
- Vibration alarm, detects feeder failure
- Auto-zero alarm, detects sticky product

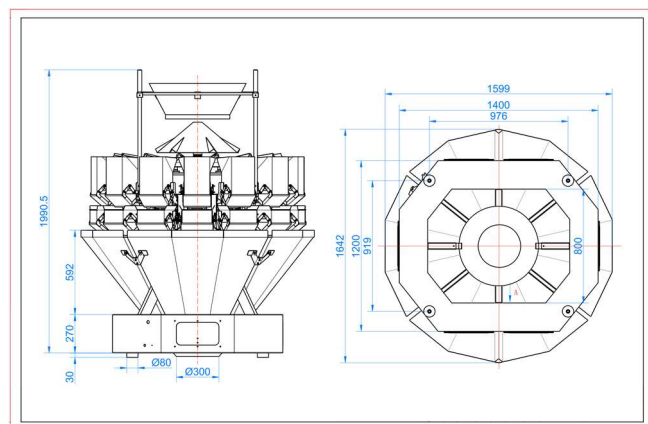

Data Sheet

MW14Li75 V40



This multihead weigher is an Industry 4.0 product. Perform diagnosis or updates online from the technical service.

Ultimate electronics with 64bit CPU, allows ultrafast and accurate combination. High efficiency drivers for vibration and motion.

With 10 heads, smooth surface and 7.5L volume, it's optimal for dosing very big dry products garlic, onion or potatoes, up to 100 d.p.m. and 1g of accuracy.

Functions for mixing, counting and calibrating are included in the firmware.

Firmware Features:

- Multi-Screen: Master / Slave support, secondary screen (tablet or mobile) can monitor the data from main control, via local network or via cloud worldwide.
- Multi-User: Remote users can login into the weigher, watch the camera in real time, get the production data not disturbing the operations in the main control.
- Windows API: Control and Monitoring of the machine can be shared to the customer ERP.
- Mobile App: Included Android app to login into the weigher via Bluetooth, local network or remote cloud and monitor the data in background or control the machine as main operator.
- Firmware Upgrade: The firmware of the CPU can be uploaded from the panel PC or cloud.

- 12" touch Panel PC with Windows 10
- Full integral control: weigher + packer
- Microsoft Excel export for statistics
- Remote connection by cloud
- HD Webcam integrated
- Stainless Steel Full IP 65
- Mixing function using very few heads.
- Units-Counting, can weight at same time
- Weight stability, detection and control
- Staggered dump, avoid product stuck
- Product alarm, pause when lack of product
- Motor sensor alarm, detects bucket failure
- Vibration alarm, detects feeder failure
- Auto-zero alarm, detects sticky product

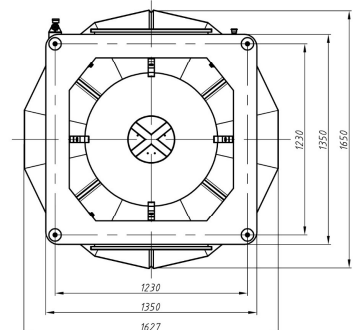
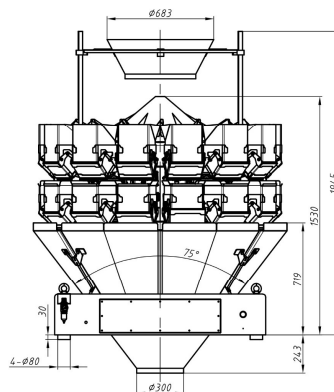

Data Sheet

MW14La50 V40



This multihead weigher is an Industry 4.0 product. Perform diagnosis or updates online from the technical service.

Ultimate electronics with 64bit CPU, allows ultrafast and accurate combination. High efficiency drivers for vibration and motion.

With 10 heads, dimple surface and 5L volume it's optimal for dosing big sticky or frozen products like meat balls, bakery or fish, up to 80 d.p.m. and 1g of accuracy.

Functions for mixing, counting and calibrating are included in the firmware.

Firmware Features:

- Multi-Screen: Master / Slave support, secondary screen (tablet or mobile) can monitor the data from main control, via local network or via cloud worldwide.
- Multi-User: Remote users can login into the weigher, watch the camera in real time, get the production data not disturbing the operations in the main control.
- Windows API: Control and Monitoring of the machine can be shared to the customer ERP.
- Mobile App: Included Android app to login into the weigher via Bluetooth, local network or remote cloud and monitor the data in background or control the machine as main operator.
- Firmware Upgrade: The firmware of the CPU can be uploaded from the panel PC or cloud.

- 12" touch Panel PC with Windows 10
- Full integral control: weigher + packer
- Microsoft Excel export for statistics
- Remote connection by cloud
- HD Webcam integrated
- Stainless Steel Full IP 65
- Mixing function using very few heads.
- Units-Counting, can weight at same time
- Weight stability, detection and control
- Staggered dump, avoid product stuck
- Product alarm, pause when lack of product
- Motor sensor alarm, detects bucket failure
- Vibration alarm, detects feeder failure
- Auto-zero alarm, detects sticky product

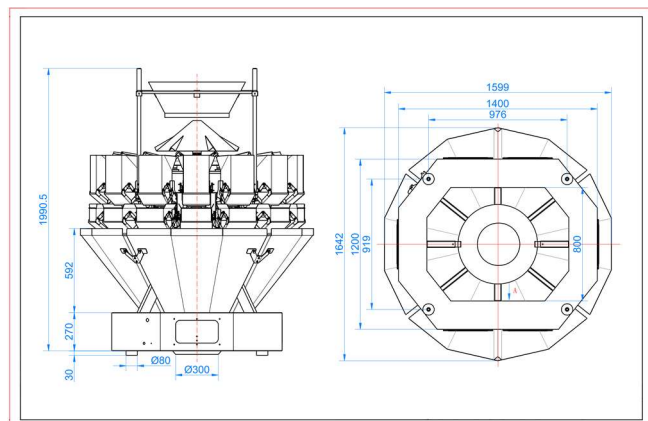

Data Sheet

MW14La75 V40



This multihead weigher is an Industry 4.0 product. Perform diagnosis or updates online from the technical service.

Ultimate electronics with 64bit CPU, allows ultrafast and accurate combination. High efficiency drivers for vibration and motion.

With 10 heads, dimple surface and 7.5L volume it's optimal for dosing very big sticky or frozen products like meat balls, bakery or fish, up to 80 d.p.m. and 1g of accuracy.

Functions for mixing, counting and calibrating are included in the firmware.

Firmware Features:

- Multi-Screen: Master / Slave support, secondary screen (tablet or mobile) can monitor the data from main control, via local network or via cloud worldwide.
- Multi-User: Remote users can login into the weigher, watch the camera in real time, get the production data not disturbing the operations in the main control.
- Windows API: Control and Monitoring of the machine can be shared to the customer ERP.
- Mobile App: Included Android app to login into the weigher via Bluetooth, local network or remote cloud and monitor the data in background or control the machine as main operator.
- Firmware Upgrade: The firmware of the CPU can be uploaded from the panel PC or cloud.

- 12" touch Panel PC with Windows 10
- Full integral control: weigher + packer
- Microsoft Excel export for statistics
- Remote connection by cloud
- HD Webcam integrated
- Stainless Steel Full IP 65
- Mixing function using very few heads.
- Units-Counting, can weight at same time
- Weight stability, detection and control
- Staggered dump, avoid product stuck
- Product alarm, pause when lack of product
- Motor sensor alarm, detects bucket failure
- Vibration alarm, detects feeder failure
- Auto-zero alarm, detects sticky product

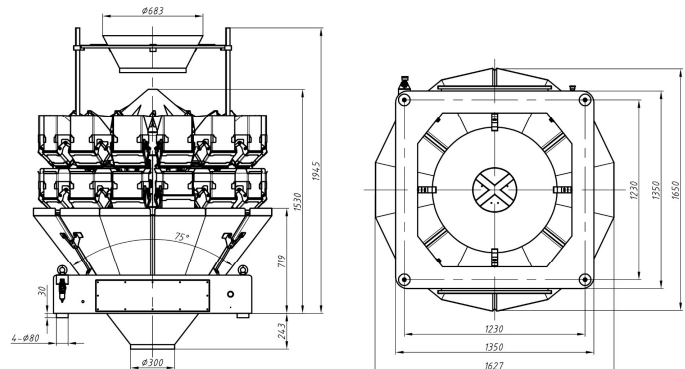

Data Sheet

AF50 V40



This auger filler machine is an Industry 4.0 product. Monitor production statistics in your mobile, from your office. Perform diagnosis or updates online, from the technical service.

Replacing the auger parts, it is suitable for material from super thin powder to granule.

Unique hopper design, GMP certification requirements: safety, health, simple, durable.

Cone hopper is combined to one set, only to remove the cone then can be cleaned. horizontally operable front half hopper, easily open doors and windows, which makes cleaning faster and easier.

Features:

- ✓ Stainless steel 304
- ✓ PLC controller with touch screen interface
- ✓ Servo-driven screw rotation
- ✓ Fast speed and high accuracy
- ✓ Waterproof Full IP65
- ✓ Inclined hand wheel of adjustable height
- ✓ Could be washed directly by water
- ✓ Meets the food industry requirements

Specifications:

- Hopper Volume 50 liters
- Filling weight 10-2000g
- Filling speed 30 dumps per minute
- Power requirements 1.9Kw
- Total Weight 220Kg
- Dimension: 1060 x 650 x 1100mm

Options:

- Contact parts stainless steel 316
- PLC + HMI

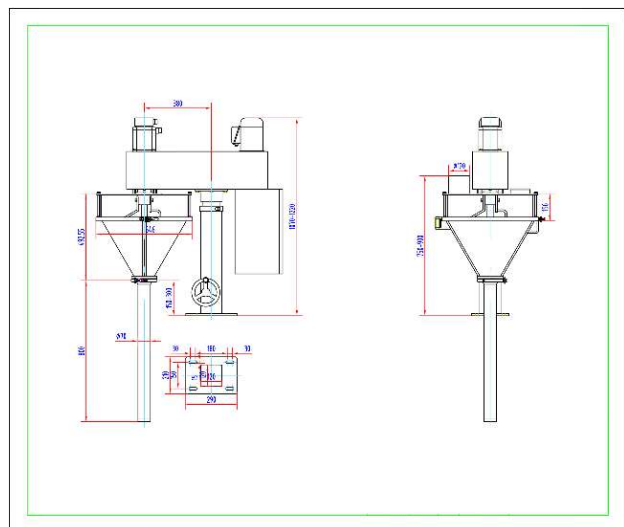

Data Sheet

AF100 V40



This auger filler machine is an Industry 4.0 product. Monitor production statistics in your mobile, from your office. Perform diagnosis or updates online, from the technical service.

Replacing the auger parts, it is suitable for material from super thin powder to granule.

Unique hopper design, GMP certification requirements: safety, health, simple, durable.

Cone hopper is combined to one set, only to remove the cone then can be cleaned. horizontally operable front half hopper, easily open doors and windows, which makes cleaning faster and easier.

Features:

- ✓ Stainless steel 304
- ✓ PLC controller with touch screen interface
- ✓ Servo-driven screw rotation
- ✓ Fast speed and high accuracy
- ✓ Waterproof Full IP65
- ✓ Inclined hand wheel of adjustable height
- ✓ Could be washed directly by water
- ✓ Meets the food industry requirements

Specifications:

- Hopper Volume 100 liters
- Filling weight 100-15000g
- Filling speed 5-10 dumps per minute
- Power requirements 3.75Kw
- Total Weight 350Kg
- Dimension: 1305 x 725 x 1100mm

Options:

- Contact parts stainless steel 316
- PLC + HMI

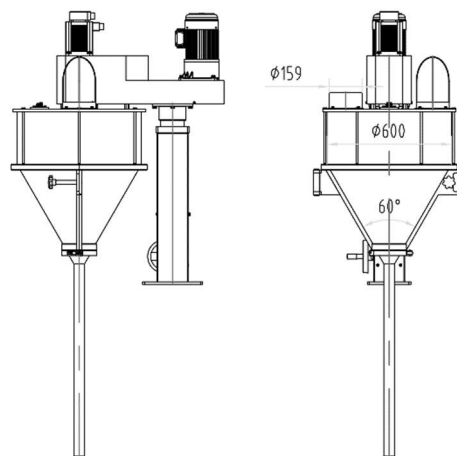

Data Sheet

VF200 V40



This vertical forming-filling-sealing machine is an Industry 4.0 product. Monitor production statistics in your mobile, from your office. Perform diagnosis or updates online, from the technical service.

The medium speed series packing machines have the capability of filling 60 bags per minute.

Loose solid material, such as puffy food, shrimp roll, peanut, popcorn, cornmeal, seed, sugar and salt etc. which shape is roll, slice and granule.

Features:

- ✓ Stainless steel frame
- ✓ PLC controller with touch screen interface
- ✓ Servo-driven film transport
- ✓ Hot printer and film feeding system synchronous
- ✓ Quickly changing one-piece bag former
- ✓ Eye mark sensor for film tracking

Specifications:

- Film width: 140-420mm
- Bag width: 60-200mm
- Bag length: 50-230mm
- Packing speed: 15-60bpm
- Air requests: 0.4m³/min, 0.6MPa
- Power supply: 220V, 50HZ, 4 Kw
- Weight: 680kgs
- Dimension: 1600x1260x1680mm

Options:

- Nitrogen gas flushing
- Gusset device
- Hole punch device
- Material stopper
- Bag support
- PE sealing system
- Static charge eliminator

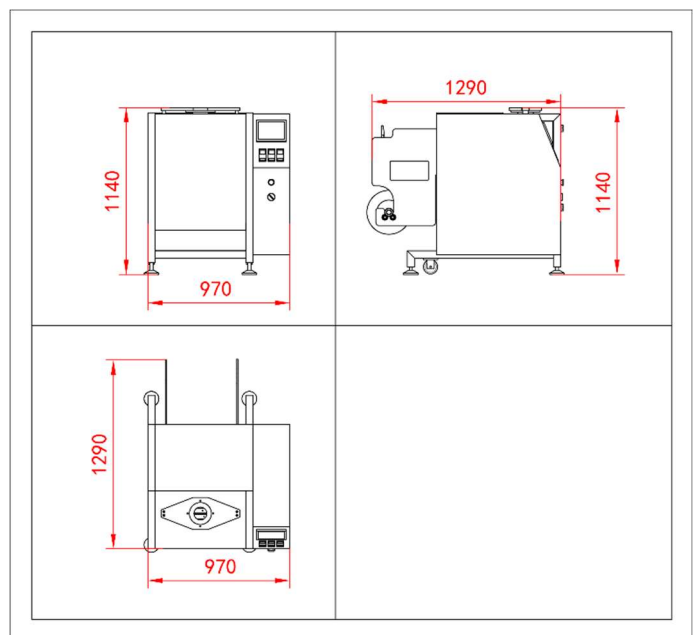

Data Sheet

VF250 V40



This vertical forming-filling-sealing machine is an Industry 4.0 product. Monitor production statistics in your mobile, from your office. Perform diagnosis or updates online, from the technical service.

The medium speed series packing machines have the capability of filling 60 bags per minute.

Loose solid material, such as puffy food, shrimp roll, peanut, popcorn, cornmeal, seed, sugar and salt etc. which shape is roll, slice and granule.

Features:

- ✓ Stainless steel frame
- ✓ PLC controller with touch screen interface
- ✓ Servo-driven film transport
- ✓ Hot printer and film feeding system synchronous
- ✓ Quickly changing one-piece bag former
- ✓ Eye mark sensor for film tracking

Specifications:

- Film width: 180-520mm
- Bag width: 80-250mm
- Bag length: 100-300mm
- Packing speed: 15-60bpm
- Air requests: 0.4m³/min, 0.6MPa
- Power supply: 220V, 50HZ, 4 Kw
- Weight: 780kgs
- Dimension: 1600x1260x1480mm

Options:

- Nitrogen gas flushing
- Gusset device
- Hole punch device
- Material stopper
- Bag support
- PE sealing system
- Static charge eliminator

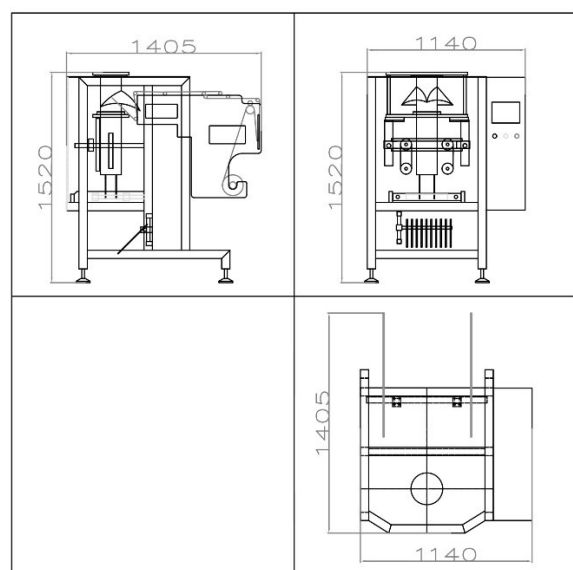

Data Sheet

VF250I V40



This vertical forming-filling-sealing machine is an Industry 4.0 product. Monitor production statistics in your mobile, from your office. Perform diagnosis or updates online, from the technical service.

The medium speed series packing machines have the capability of filling 60 bags per minute.

Inclined models are optimal for fragile products, like ice, cherry tomato or berries.

Features:

- ✓ Stainless steel frame
- ✓ PLC controller with touch screen interface
- ✓ Servo-driven film transport
- ✓ Hot printer and film feeding system synchronous
- ✓ Quickly changing one-piece bag former
- ✓ Eye mark sensor for film tracking

Specifications:

- Max. film width: 520mm
- Bag width: 80-250mm
- Bag length: 50-300mm
- Packing speed: 15-60bpm
- Air requests: 0.4m³/min, 0.6MPa
- Power supply: 220V, 50HZ, 4 Kw
- Weight: 680kgs

Options:

- Nitrogen gas flushing
- Gusset device
- Hole punch device
- Material stopper
- Bag support
- PE sealing system
- Static charge eliminator

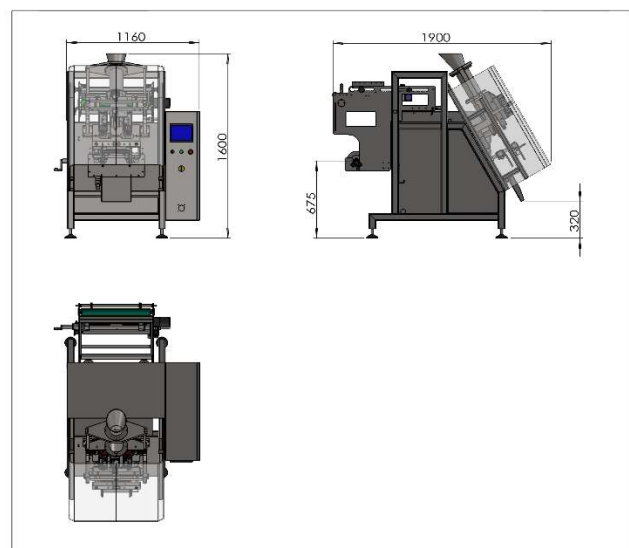

Data Sheet

VF300 V40



This vertical forming-filling-sealing machine is an Industry 4.0 product. Monitor production statistics in your mobile, from your office. Perform diagnosis or updates online, from the technical service.

The BH series packing machines have the capability of filling 60 bags per minute.

Loose solid material, such as puffy food, shrimp roll, peanut, popcorn, cornmeal, seed, sugar and salt etc. which shape is roll, slice and granule.

Features:

- ✓ Stainless steel frame
- ✓ PLC controller with touch screen interface
- ✓ Servo-driven film transport
- ✓ Hot printer and film feeding system synchronous
- ✓ Quickly changing one-piece bag former
- ✓ Eye mark sensor for film tracking

Specifications:

- Film width: 220-620mm
- Bag width: 100-300mm
- Bag length: 100-380mm
- Packing speed: 15-60bpm
- Air requests: 0.4m³/min, 0.6MPa
- Power supply: 220V, 50HZ, 4 Kw
- Weight: 680kgs
- Dimension: 1600x1260x1680mm

Options:

- Nitrogen gas flushing
- Gusset device
- Hole punch device
- Material stopper
- Bag support
- PE sealing system
- Static charge eliminator

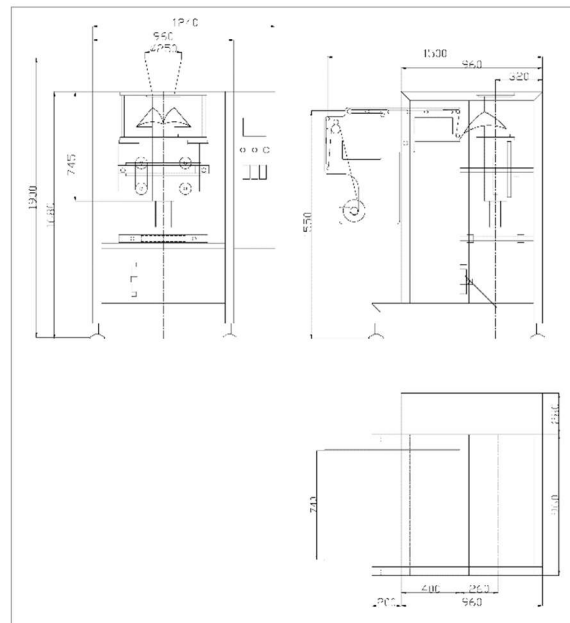

Data Sheet

VF300L V40



This vertical forming-filling-sealing machine is an Industry 4.0 product. Monitor production statistics in your mobile, from your office. Perform diagnosis or updates online, from the technical service.

The medium series packing machines have the capability of filling 60 bags per minute. Low profile version is optimal for small room.

Loose solid material, such as puffy food, shrimp roll, peanut, popcorn, cornmeal, seed, sugar and salt etc. which shape is roll, slice and granule.

Features:

- ✓ Stainless steel frame
- ✓ PLC controller with touch screen interface
- ✓ Servo-driven film transport
- ✓ Hot printer and film feeding system synchronous
- ✓ Quickly changing one-piece bag former
- ✓ Eye mark sensor for film tracking

Specifications:

- Film width: 220-620mm
- Bag width: 100-300mm
- Bag length: 100-380mm
- Packing speed: 15-60bpm
- Air requests: 0.4m³/min, 0.6MPa
- Power supply: 220V, 50HZ, 4 Kw
- Weight: 680kgs
- Dimension: 1600x1260x1680mm

Options:

- Nitrogen gas flushing
- Gusset device
- Hole punch device
- Material stopper
- Bag support
- PE sealing system
- Static charge eliminator

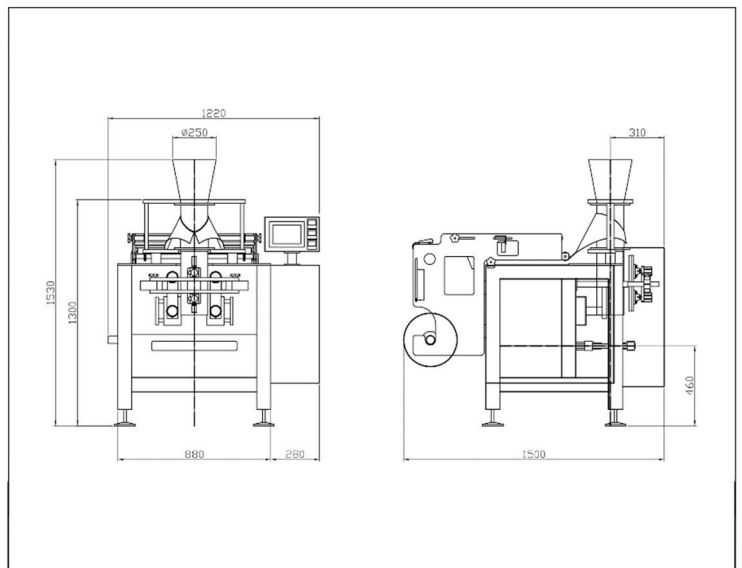

Data Sheet

VF300I V40



This vertical forming-filling-sealing machine is an Industry 4.0 product. Monitor production statistics in your mobile, from your office. Perform diagnosis or updates online, from the technical service.

The medium speed series packing machines have the capability of filling 60 bags per minute.

Inclined models are optimal for fragile products, like ice, cherry tomato or berries.

Features:

- ✓ Stainless steel frame
- ✓ PLC controller with touch screen interface
- ✓ Servo-driven film transport
- ✓ Hot printer and film feeding system synchronous
- ✓ Quickly changing one-piece bag former
- ✓ Eye mark sensor for film tracking

Specifications:

- Max. film width: 620mm
- Bag width: 80-300mm
- Bag length: 50-380mm
- Packing speed: 15-60bpm
- Air requests: 0.4m³/min, 0.6MPa
- Power supply: 220V, 50HZ, 4 Kw
- Weight: 680kgs
- Dimension: 1600x1260x1680mm

Options:

- Nitrogen gas flushing
- Gusset device
- Hole punch device
- Material stopper
- Bag support
- PE sealing system
- Static charge eliminator

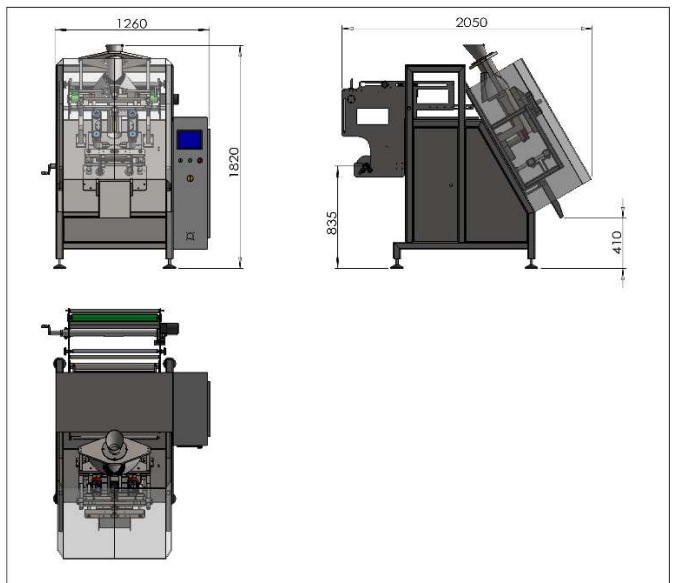

Data Sheet

VF390 V40



This vertical forming-filling-sealing machine is an Industry 4.0 product. Monitor production statistics in your mobile, from your office. Perform diagnosis or updates online, from the technical service.

The mid speed series packing machines have the capability of filling 60 bags per minute.

Loose solid material, such as puffy food, shrimp roll, peanut, popcorn, cornmeal, seed, sugar and salt etc. which shape is roll, slice and granule.

Features:

- ✓ Stainless steel frame
- ✓ PLC controller with touch screen interface
- ✓ Servo-driven film transport
- ✓ Hot printer and film feeding system synchronous
- ✓ Quickly changing one-piece bag former
- ✓ Eye mark sensor for film tracking

Specifications:

- Film width: 300-820mm
- Bag width: 160-390mm
- Bag length: 50-480mm
- Packing speed: 10-30bpm
- Air requests: 0.7m³/min, 0.6MPa
- Power supply: 220V, 50HZ, 4.5 Kw

Options:

- Nitrogen gas flushing
- Gusset device
- Hole punch device
- Material stopper
- Bag support
- PE sealing system
- Static charge eliminator

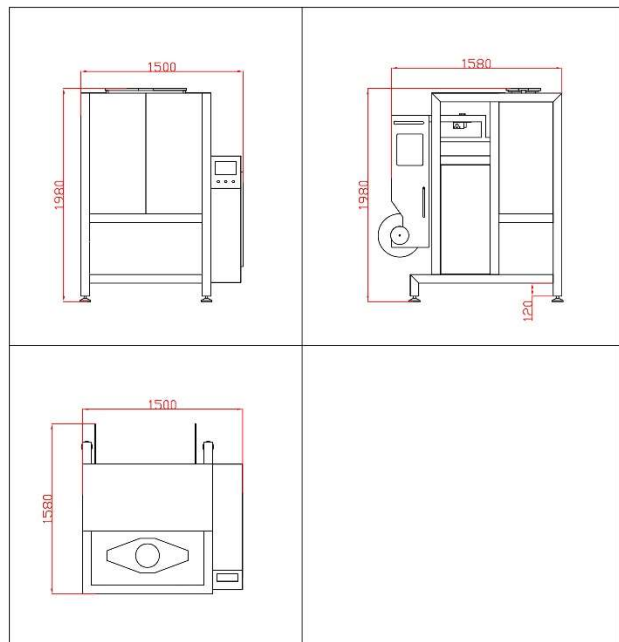

Data Sheet

VF480 V40



This vertical forming-filling-sealing machine is an Industry 4.0 product. Monitor production statistics in your mobile, from your office. Perform diagnosis or updates online, from the technical service.

Ultra-large packing machines series VF1000 with film width from 500mm to 1000mm and filling range from 5 to 25Kg.

Applications: Pet food, rice, flour, sugar, fodder, fertilizer, bakery, ice, etc.

Features:

- ✓ Simple in structure and reliable in control
- ✓ Standard thermal seal for laminated film (standard version)
- ✓ Instant impulse seal for single-layer PE film (Option)
- ✓ Different operating languages available
- ✓ Fits for working with different fillers or weighers
- ✓ Suit for packing granular, powder or liquid

Specifications:

- Film width: 500-1000mm
- Bag width: 240-480mm
- Bag length: 100-600mm
- Packing speed: Max. 30bpm
- Power supply: 220V, 50HZ, 5Kw
- Air requests: 0.6m³/min, 0.6Mpa
- Dimension: 2170x1780x2740mm

Options:

- Nitrogen gas flushing
- Gusset device
- Hole punch device
- Material stopper
- Bag support
- PE sealing system
- Static charge eliminator

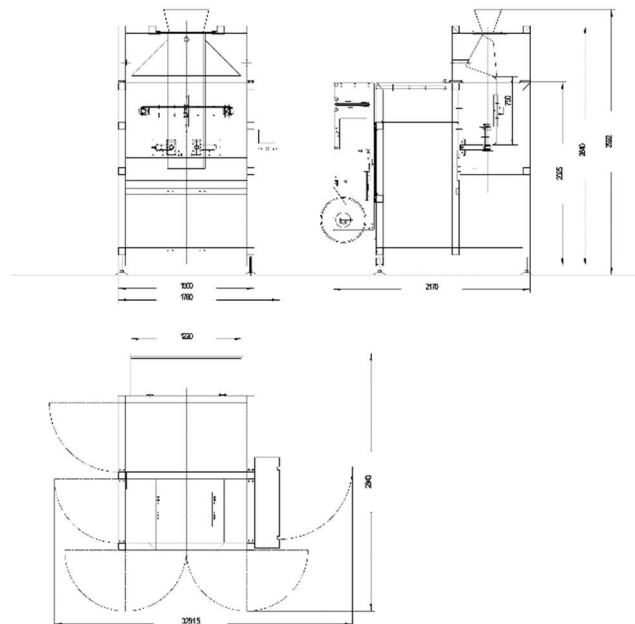

Data Sheet

VF580 V40



This vertical forming-filling-sealing machine is an Industry 4.0 product. Monitor production statistics in your mobile, from your office. Perform diagnosis or updates online, from the technical service.

Ultra-large packing machines series VF580 with film width from 600mm to 1200mm and filling range from 5 to 30Kg.

Applications: Pet food, rice, flour, sugar, fodder, fertilizer, bakery, ice, etc.

Features:

- ✓ Simple in structure and reliable in control
- ✓ Standard thermal seal for laminated film (standard version)
- ✓ Instant impulse seal for single-layer PE film (Option)
- ✓ Different operating languages available
- ✓ Fits for working with different fillers or weighers
- ✓ Suit for packing granular, powder or liquid

Specifications:

- Film width: 600-1200mm
- Bag width: 290-580mm
- Bag length: 100-800mm
- Packing speed: Max. 25bpm
- Power supply: 220V, 50HZ, 6Kw
- Air requests: 0.8m³/min, 0.6Mpa
- Dimension: 2170x1780x2740mm

Options:

- Nitrogen gas flushing
- Gusset device
- Hole punch device
- Material stopper
- Bag support
- PE sealing system
- Static charge eliminator

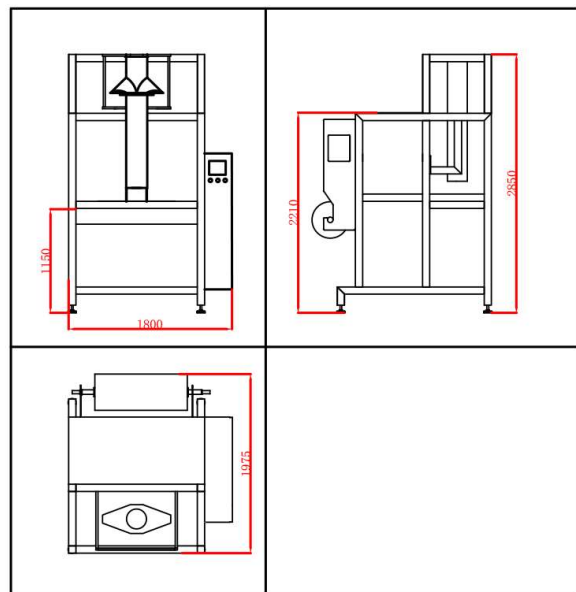

Data Sheet

VF100 4L V40



This vertical forming-filling-sealing machine is an Industry 4.0 product. Monitor production statistics in your mobile, from your office. Perform diagnosis or updates online, from the technical service.

Four lanes series have the capability of filling 4 small size bags at same time, up to 240 per minute.

Suitable to use with nuts, popcorn, seed, sugar and salt, etc. which shape is roll, slice and granule.

Features:

- ✓ Stainless steel structure.
- ✓ Can combine with four outlets multihead weigher.
- ✓ High-end motion controller with servo system, ensure easy operating.
- ✓ Servo-driven for film pulling system.
- ✓ Pneumatic end seal system, end seal for pulling film.
- ✓ Date printer and film feeding system synchronous working.
- ✓ Photo sensor for automatic tracking eye marks.

Specifications:

- Film width: 520-900mm
- Bag width: 55-102mm (single)
- Bag length: 50-250mm
- Max. speed: 240bpm
- Power: 380V, 50/60HZ, 6.3KW
- Air request: 1.4m³/min, 0.6Mpa
- Dimension: 1800x1600x1760mm

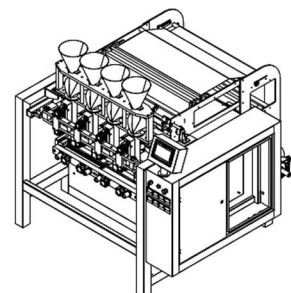
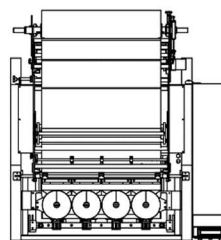
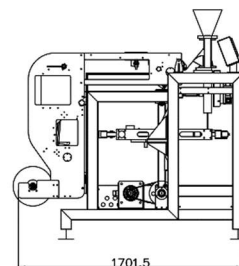
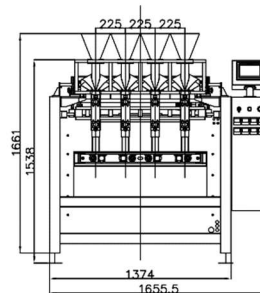

Data Sheet

VX300 V40



This vertical forming-filling-sealing machine is an Industry 4.0 product. Monitor production statistics in your mobile, from your office. Perform diagnosis or updates online, from the technical service.

The high-speed packing machines have the capability of filling 90 bags per minute.

Loose solid material, such as puffy food, shrimp roll, peanut, popcorn, cornmeal, seed, sugar and salt etc. which shape is roll, slice and granule.

Features:

- ✓ Stainless steel frame
- ✓ PLC controller with touch screen interface
- ✓ Servo-driven film transport
- ✓ Servo-driven jaws
- ✓ Hot printer and film feeding system synchronous
- ✓ Quickly changing one-piece bag former
- ✓ Eye mark sensor for film tracking

Specifications:

- Film width: 220-620mm
- Bag width: 100-300mm
- Bag length: 100-380mm
- Packing speed: 15-60bpm
- Air requests: 0.4m³/min, 0.6MPa
- Power supply: 220V, 50HZ, 4 Kw
- Weight: 680kgs
- Dimension: 1600x1260x1680mm

Options:

- Nitrogen gas flushing
- Gusset device
- Hole punch device
- Material stopper
- Bag support
- PE sealing system
- Static charge eliminator

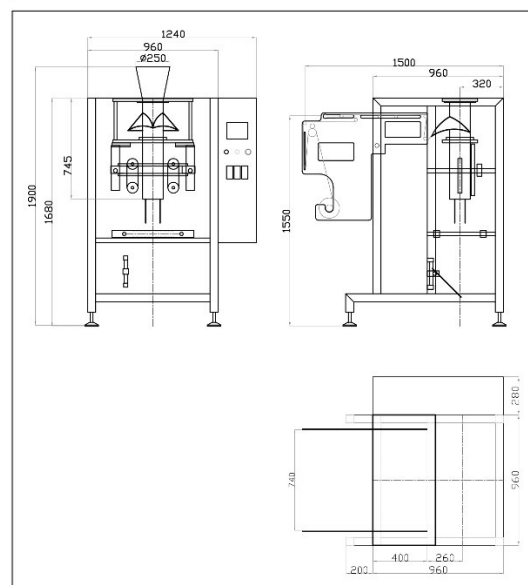

Data Sheet

VX300L V40



This vertical forming-filling-sealing machine is an Industry 4.0 product. Monitor production statistics in your mobile, from your office. Perform diagnosis or updates online, from the technical service.

The high-speed series packing machines have the capability of filling 90 bags per minute. Low profile version is optimal for small room.

Loose solid material, such as puffy food, shrimp roll, peanut, popcorn, cornmeal, seed, sugar and salt etc. which shape is roll, slice and granule.

Features:

- ✓ Stainless steel frame
- ✓ PLC controller with touch screen interface
- ✓ Servo-driven film transport
- ✓ Servo-driven jaws
- ✓ Hot printer and film feeding system synchronous
- ✓ Quickly changing one-piece bag former
- ✓ Eye mark sensor for film tracking

Specifications:

- Film width: 220-620mm
- Bag width: 100-300mm
- Bag length: 100-380mm
- Packing speed: 15-60bpm
- Air requests: 0.4m³/min, 0.6MPa
- Power supply: 220V, 50HZ, 4 Kw
- Weight: 680kgs
- Dimension: 1600x1260x1680mm

Options:

- Nitrogen gas flushing
- Gusset device
- Hole punch device
- Material stopper
- Bag support
- PE sealing system
- Static charge eliminator

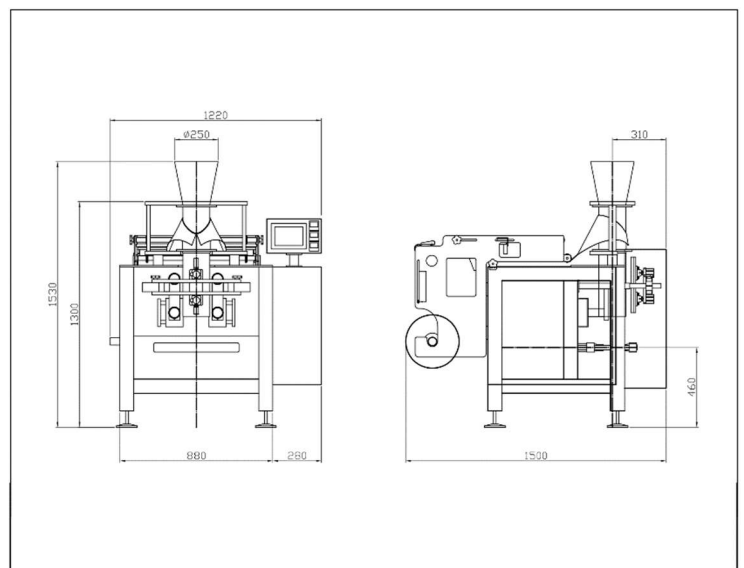

Data Sheet

VZ250 V40



This vertical forming-filling-sealing machine is an Industry 4.0 product. Monitor production statistics in your mobile, from your office. Perform diagnosis or updates online, from the technical service.

The high-speed continuous series packing machines with 4 servos have the capability of filling 120 bags per minute.

Features:

- ✓ Stainless steel frame
- ✓ PLC controller with touch screen interface
- ✓ Two Servo controls belt pull motivation
- ✓ One Servo controls is Transverse sealing
- ✓ One servo horizontal sealing motivation
- ✓ Hot printer and film feeding system synchronous
- ✓ Quickly changing one-piece bag former
- ✓ Eye mark sensor for film tracking

Specifications:

- Max. film width: 520mm
- Bag width: 50-250mm
- Bag length: 50-400mm
- Packing speed: 15-120bpm
- Air requests: 0.2m³/min, 0.6MPa
- Power supply: 220V, 50HZ, 5 Kw

Options:

- Nitrogen gas flushing
- Gusset device
- Hole punch device
- Material stopper
- Bag support
- PE sealing system
- Static charge eliminator

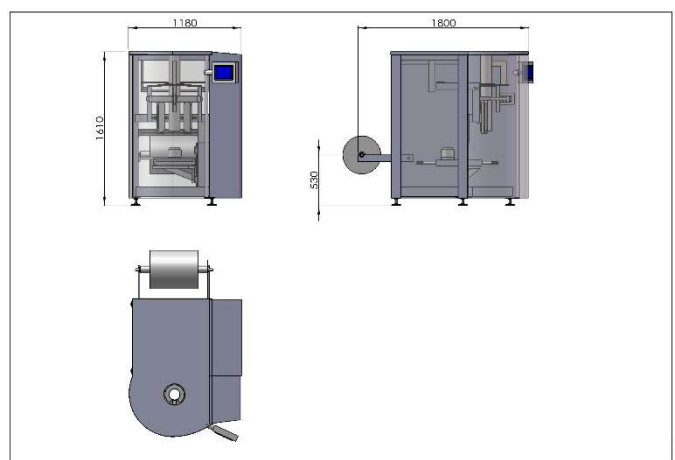

Data Sheet

FP320 V40



This horizontal forming-filling-sealing machine is an Industry 4.0 product. Monitor the production statistics in your mobile, from your office. Perform any diagnosis or updates online from the technical service.

The flow-pack series packing machines with 3 servo motors have the capability of packing one or multiple pieces up to 80 bags per minute.

Features:

- ✓ 2 reel holder with auto centering and locking device.
- ✓ 2 sets of longitudinal sealing wheels, one cold and one hot.
- ✓ Misplaced Item Skip device
- ✓ High sensitive photoelectric eye color tracking
- ✓ Adjustable forming box.
- ✓ 3 meters (in length) infeed conveyor with adjustable guides.
- ✓ Top brush belt assist products passing through transversal sealing.
- ✓ Alarm device for emergency stop.
- ✓ Easy to clean.

Specifications:

- Max. film width : 720
- Bag length: 180-600mm
- Bag width: 40-320mm
- Bag weight: 5-150mm
- Packing speed : 20~80 bpm
- Power supply: 220V, 50Hz, 4.5KW
- Dimensions: 4700 X 1400 X 1900mm
- Machine weight: 1500Kg

Options:

- Nitrogen gas flushing
- Gusset device
- Hole punch device

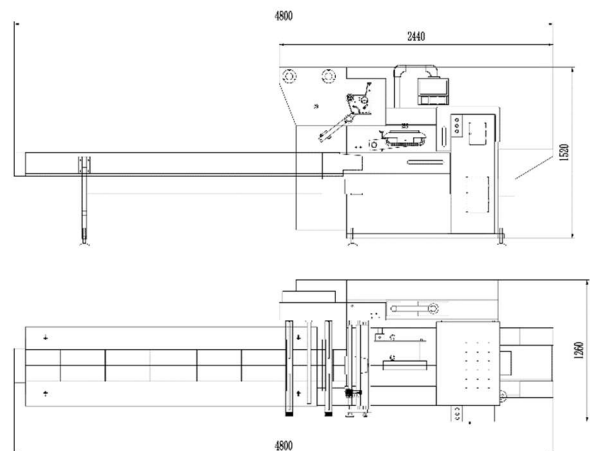

Data Sheet

DP15L V40



This doypack machine is an Industry 4.0 product. Monitor production statistics in your mobile, from your office. Perform diagnosis or updates online, from the technical service.

Used to fill preformed bags with granular products, powders or [ready-to-drink](#) beverages. They can be [aseptically](#) filled.

Main advantages are presenting the product in an upright position, large surface for printing, possibility of zipper closing and price lower than other alternative packaging system.

Features:

- ✓ Stainless steel frame 3mm thickness
- ✓ PLC controller with touch screen interface
- ✓ Bag loading, pouch loader is adjustable for different size
- ✓ Bag detection, No bag = No dump
- ✓ Transition chute, product is dispensed immediately
- ✓ Digital sealing, pouches are sealed in place eliminating wrinkles
- ✓ Low operating and maintenance cost

Specifications:

- Bag width: 130-300mm
- Bag length: 130-420mm
- Packing speed: 18 bpm
- Air requests: 0.4m³/min, 0.6MPa
- Power supply: 220V, 50HZ, 1.2Kw

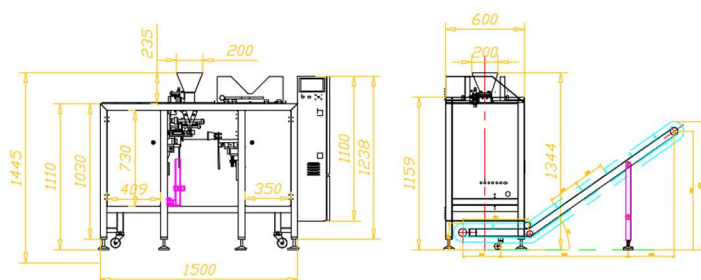

Options:

- Horizontal zipper opener
- Moving device for InkJet
- Heavy product stopper
- Quick release exit conveyor

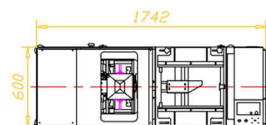

Data Sheet

DP30D V40



This doypack machine is an Industry 4.0 product. Monitor production statistics in your mobile, from your office. Perform diagnosis or updates online, from the technical service.

Used to fill preformed bags with granular products, powders or [ready-to-drink](#) beverages. They can be [aseptically](#) filled.

Main advantages are presenting the product in an upright position, large surface for printing, possibility of zipper closing and price lower than other alternative packaging system.

Features:

- ✓ Stainless steel frame 3mm thickness
- ✓ PLC controller with touch screen interface
- ✓ Bag loading, pouch loader is adjustable for different size
- ✓ Bag detection, No bag = No dump
- ✓ Transition chute, product is dispensed immediately
- ✓ Digital sealing, pouches are sealed in place eliminating wrinkles
- ✓ Low operating and maintenance cost

Specifications:

- Bag width: 80-200mm
- Bag length: 130-300mm
- Packing speed: 30 bpm
- Air requests: 0.4m³/min, 0.6MPa
- Power supply: 220V, 50HZ, 1.2Kw

Options:

- Horizontal zipper opener
- Moving device for InkJet
- Heavy product stopper
- Quick release exit conveyor

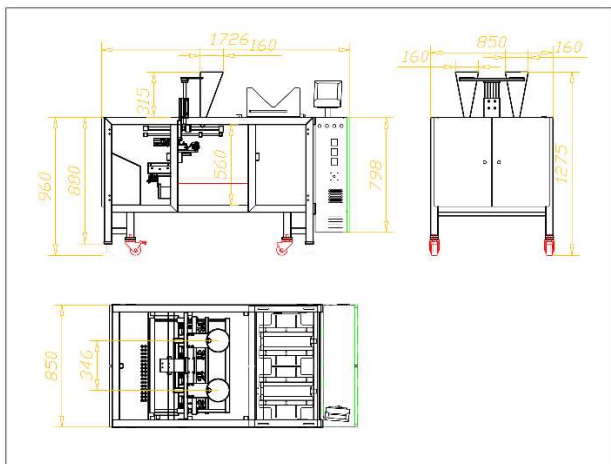

Data Sheet

DP210 V40



This doypack machine is an Industry 4.0 product. Monitor production statistics in your mobile, from your office. Perform diagnosis or updates online, from the technical service.

Used to fill preformed bags with granular products, powders or [ready-to-drink](#) beverages. They can be [aseptically](#) filled.

Main advantages are presenting the product in an upright position, large surface for printing, possibility of zipper closing and price lower than other alternative packaging system.

Features:

- ✓ Stainless steel frame 3mm thickness
- ✓ PLC controller with touch screen interface
- ✓ Bag loading, pouch loader is adjustable for different size
- ✓ Bag detection, No bag = No dump
- ✓ Transition chute, product is dispensed immediately
- ✓ Digital sealing, pouches are sealed in place eliminating wrinkles
- ✓ Low operating and maintenance cost

Specifications:

- Bag width: 120-210mm
- Bag length: 140-280mm
- Packing speed: 30 bpm
- Air requests: 0.4m³/min, 0.6MPa
- Power supply: 220V, 50HZ, 1.2Kw

Options:

- Horizontal zipper opener
- Moving device for InkJet
- Heavy product stopper
- Quick release exit conveyor

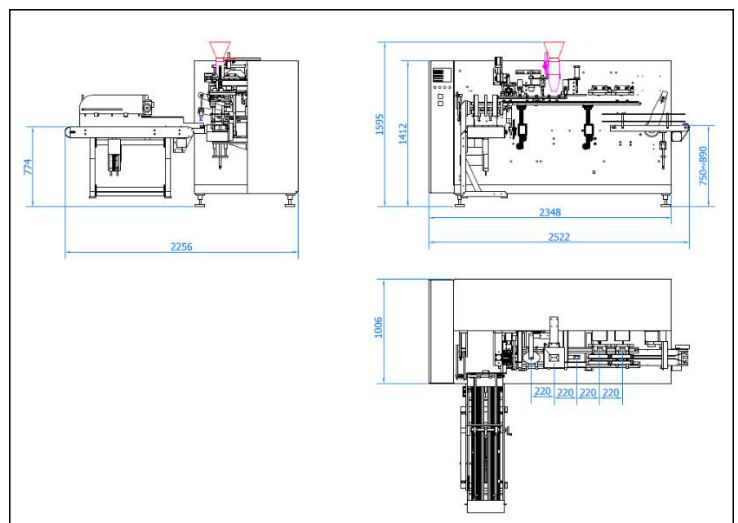

Data Sheet

CW300 V40



This combo checkweigher plus metal detector is an Industry 4.0 product, giving connectivity to Internet, allowing to get the statistics data, total transits and rejects, from anywhere in the world with a mobile.

This connectivity eases the technical assistance, software upgrades and reliability.

Product Description:

The dynamic checkweigher CW300 V40 can check up to 200 packets per minute rejecting products out of weight, according European normative. Equipped with HBM® loadcell, leader in weighing systems and its integrated digital transceiver, this checkweigher is immune to electrical perturbations and mechanic noise.

- 304 Stainless Steel
- 12" Color touch screen
- Windows 10 HMI
- Wifi and Bluetooth
- HBM® digital system
- Range: 10g to 10kg
- Max. Speed: 200 b/m
- 3 Belts custom speed
- IP65 protection
- Up to 1000 recipes
- Lan connection
- Remote Service
- Industry 4.0 product

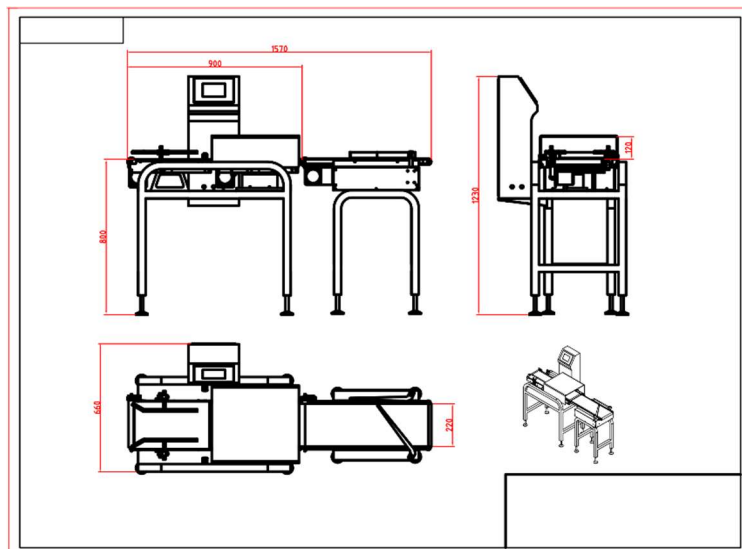

Data Sheet

CW300MD V40



This combo checkweigher plus metal detector is an Industry 4.0 product, giving connectivity to Internet, allowing to get the statistics data, total transits and rejects, from anywhere in the world with a mobile.

This connectivity eases the technical assistance, software upgrades and reliability.

Product Description:

The dynamic checkweigher CW-MD V40 can check up to 200 packets per minute rejecting products out of weigh, according European normative. Equipped with HBM® loadcell, leader in weighing systems and its integrated digital transceiver, this checkweigher is immune to electrical perturbations and mechanic noise.

In combination with an integrated metal detector the CW-MD V40 ensures products containing metal particles are safely rejected. Equipped with Ceia® metal detector, world leading brand, this system is the best detecting imperceptible contaminants.

- 304 Stainless Steel
- 12" Color touch screen
- Windows 10 HMI
- Wifi and Bluetooth
- HBM® digital system
- Ceia® Metal Detector
- Range: 10g to 10kg
- Max. Speed: 200 b/m
- 3 Belts custom speed
- IP65 protection
- Up to 1000 recipes
- Lan connection
- Remote Service
- Industry 4.0 product

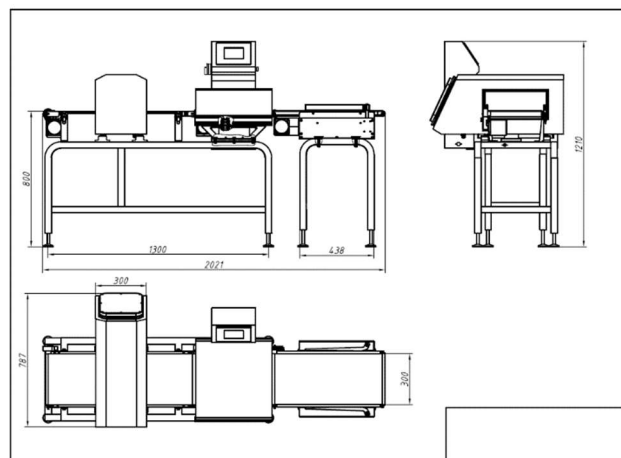

Data Sheet

CWH300 V40



This checkweigher is an Industry 4.0 product, giving connectivity to Internet, allowing to get the statistics data, total transits and rejects, from anywhere in the world with a mobile.

This connectivity eases the technical assistance, software upgrades and reliability.

Product Description:

The dynamic checkweigher CWH300 can check up to 100 packets per minute rejecting products out of weigh with 1g accuracy, according European normative.

This equipment is homologated with M.I.D. certification (Measurement Instruments Directive) which allows you to print 'e' certification on the product label.

- 304 Stainless Steel
- 12" Color touch screen
- Windows 10 Pro HMI
- Connection LAN and Bluetooth
- HBM® digital system
- Range: 10g to 10kg
- Max. Speed: 100 b/m
- 3 Belts custom speed
- IP65 protection
- Up to 1000 recipes
- Remote Service
- Industry 4.0 product

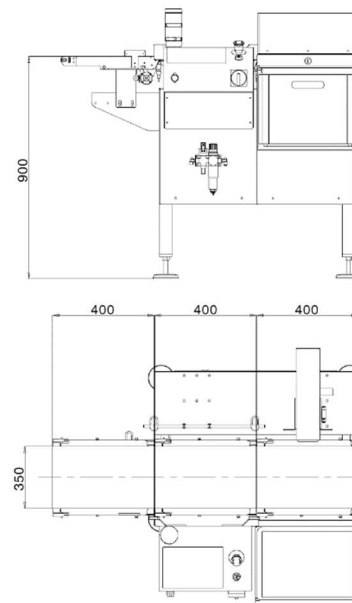

Data Sheet

CWH300MD V40



This combo checkweigher plus metal detector is an Industry 4.0 product, giving connectivity to Internet, allowing to get the statistics data, total transits and rejects, from anywhere in the world with a mobile.

This connectivity eases the technical assistance, software upgrades and reliability.

Product Description:

The dynamic checkweigher CWH300MD can check up to 100 packets per minute rejecting products out of weigh, according European normative. This equipment is homologated, which allows you to print 'e' certification on the product label.

In combination with an integrated metal detector the CWH300MD ensures products containing metal particles are safely rejected. Equipped with Ceia® MultiSpectrum metal detector, world leading brand, this system is the best detecting imperceptible contaminants.

- 304 Stainless Steel
- 12" Color touch screen
- Windows 10 HMI
- Connection LAN and Bluetooth
- HBM® digital system
- Ceia® MultiSpectrum
- Range: 10g to 10kg
- Max. Speed: 100 b/m
- 3 Belts custom speed
- IP65 protection
- Up to 1000 recipes
- Remote Service
- Industry 4.0 product

